

Soviet light cruiser Pr.68-bis

Admiral Lazarev

1/700

Displacement:..13,340 t/16,340t
Length:.....210.0 m
Beam:.....22.0 m
Draft.....7.3 m
Installed power..... 121700 hp
Speed:..... 32 knots
Range:.....7.400 nmi
Armament:

4 × 3 – 152 mm МК-5-бис
6 × 2 – 100 mm СМ-5-1С
12 × 2 – 37 mm В-11
2 × 533-mm torpedo tube
ПТА-53-68bis

Armor:
Belt: 100 mm
Barbettes: 130 mm
Deck: 50 mm

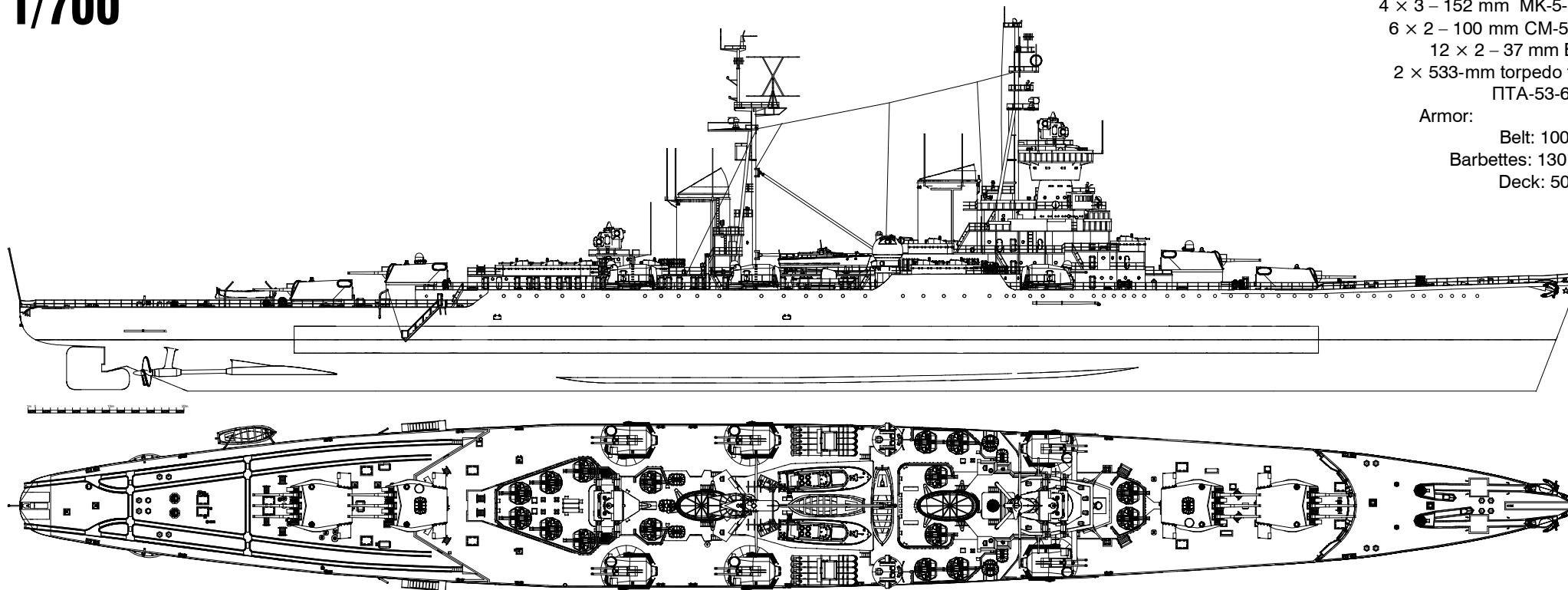

Лёгкий крейсер пр. 68-бис «Адмирал Лазарев» был заложен 6 февраля 1951 г. в Ленинграде на судостроительном заводе №194 им. А.Марти. Спущен на воду 29 июня 1952 г., вступил в строй 30 декабря 1953 г. Корабль был построен с учётом опыта Второй мировой войны и прогресса отечественного и зарубежного судостроения. В 1956 году осуществил переход по Северному морскому пути из Североморска на Дальний Восток, где вошёл в состав КТОФ. В 1963 году крейсер был выведен из боевого состава флота, законсервирован и поставлен на отстой в Советской Гавани. В 1972 году расконсервирован и вновь введён в строй. В период с 1980 по 1986 годы КРЛ «Адмирал Лазарев» прошёл капитальный ремонт на Дальзаводе во Владивостоке, после чего был разоружён и исключён из состава ВМФ. В 1991 г. продан частной фирме в Индию для разделки на металл.

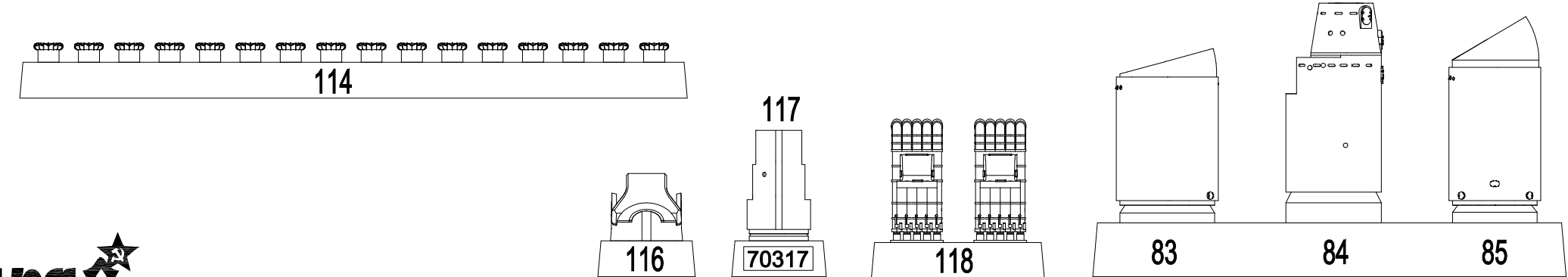
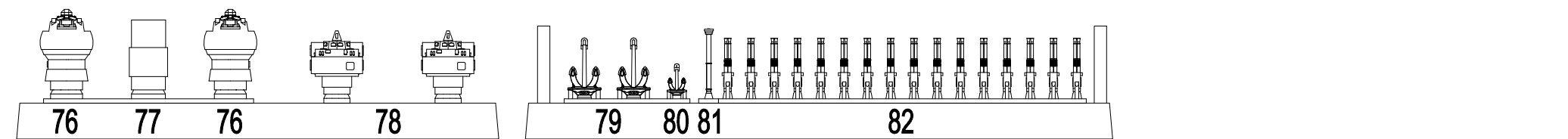
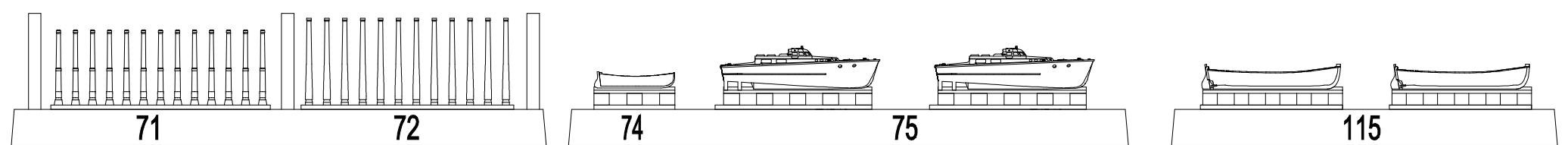
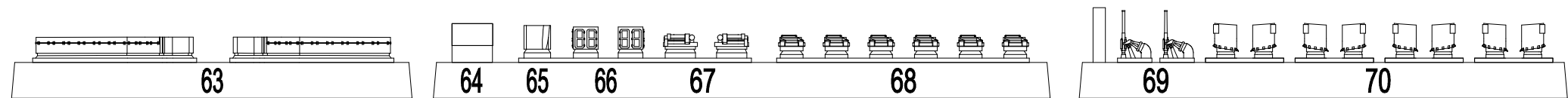
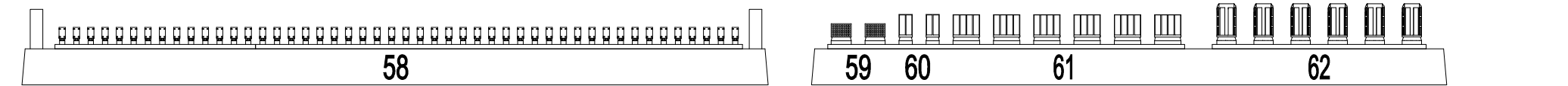
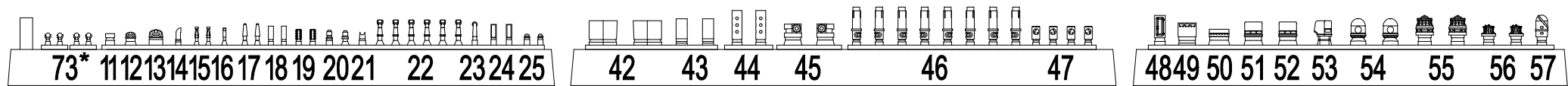
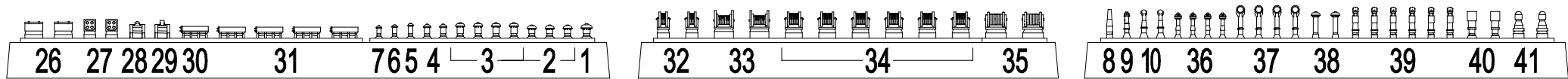

* -additional searchlights

For more info on Combrig kits see: www.combrig-models.com www.steelnavy.net www.modelwarships.com 70317

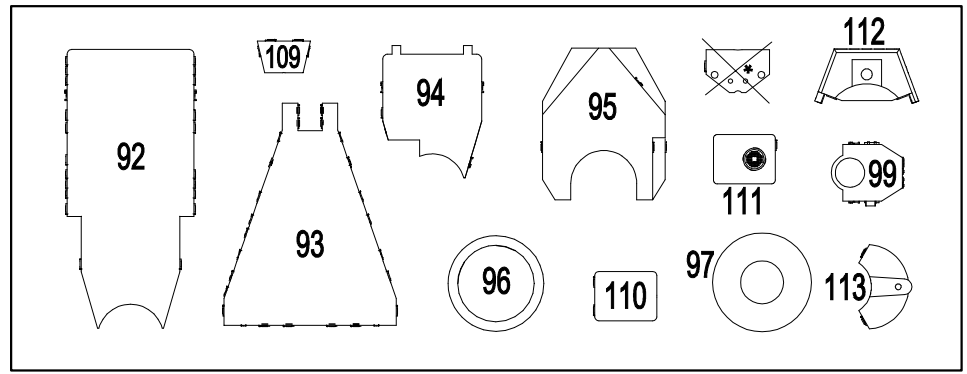
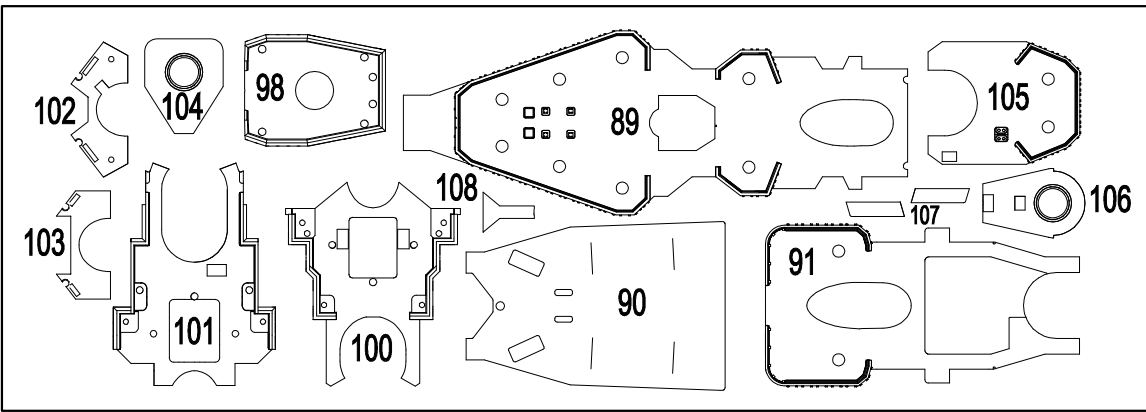
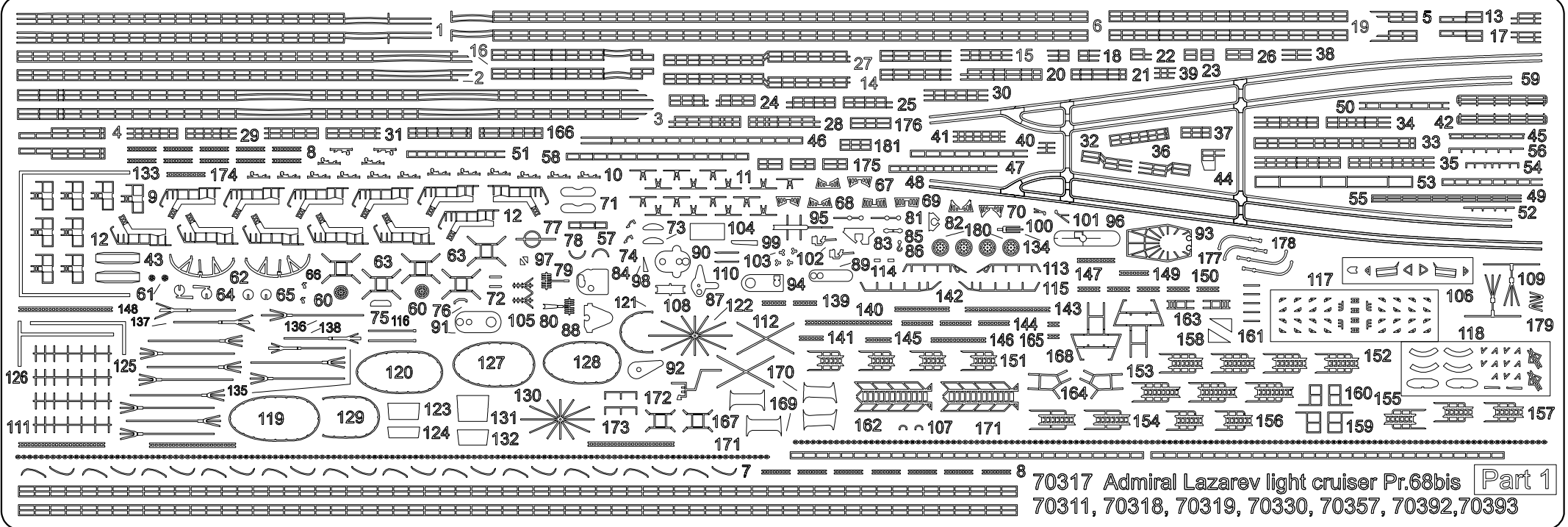

* -the part is not used

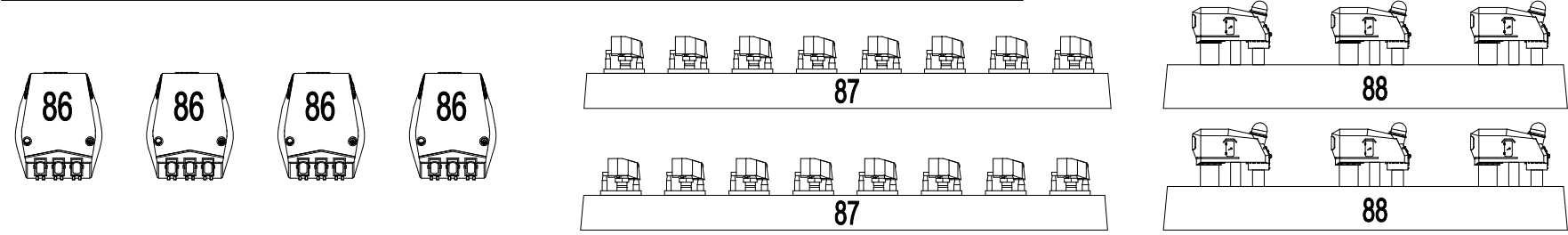

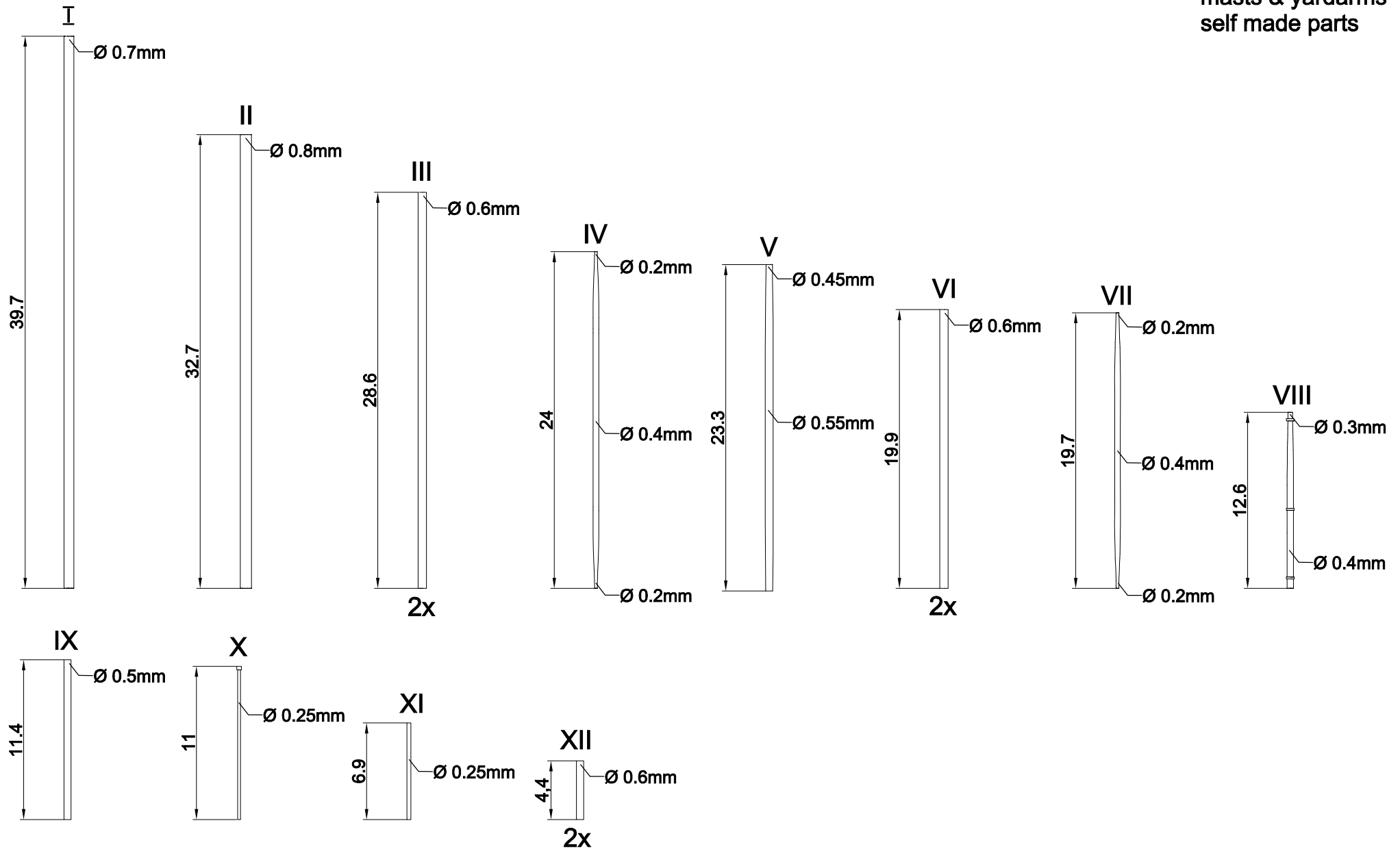

 Please note that the assembly guide reflects the position of the parts when installed only, and not the exact order of the assembly.
To download the assembly instructions in PDF (high resolution) please visit www.combrig-models.com

A2

152-мм корабельные пушки В-38 в трёхорудийных башнях МК-5 бис

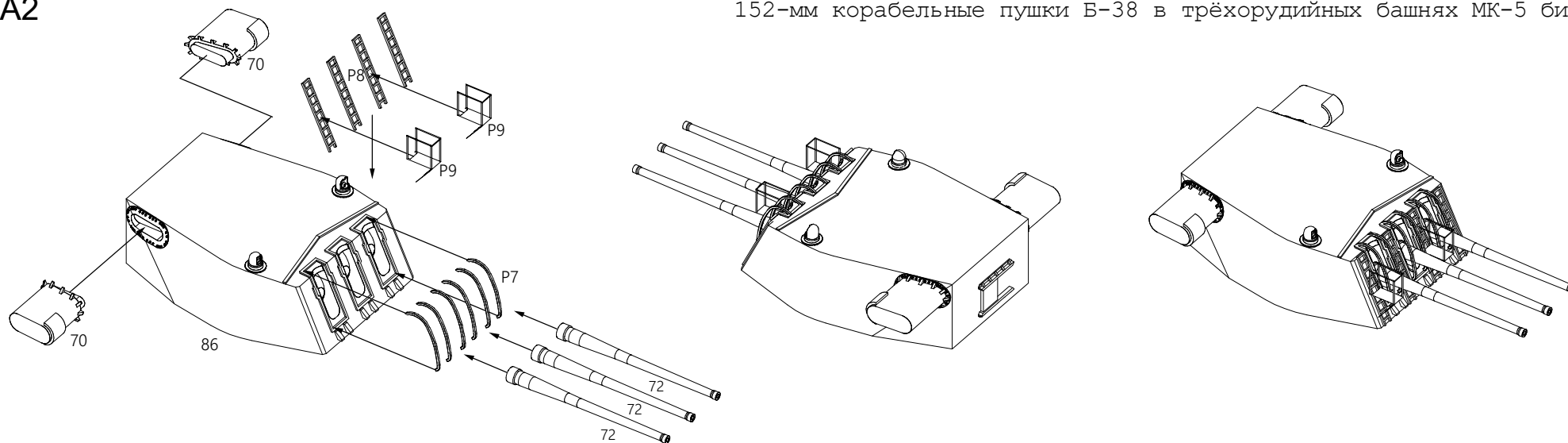

4x

A3

100-мм универсальное орудие СМ-5-1С

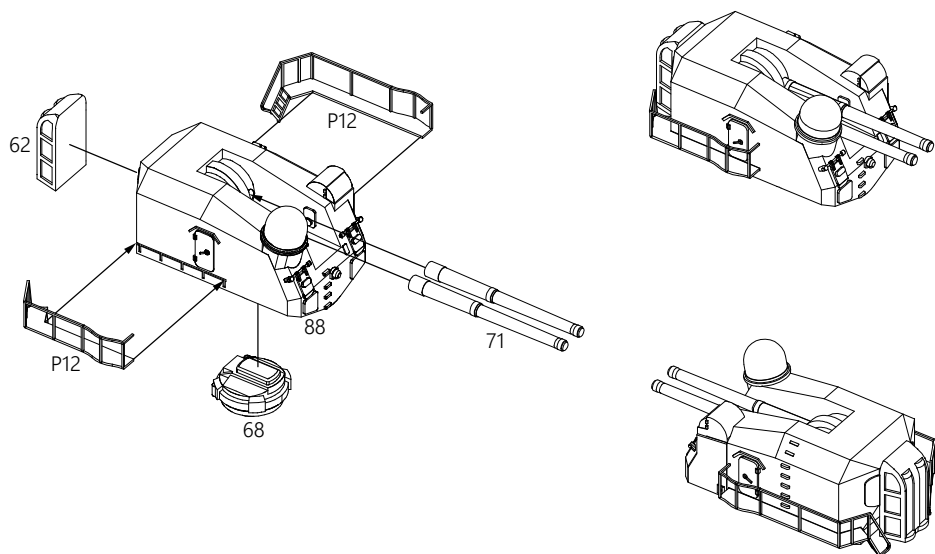

6x

A1

В-11 37-мм спаренное корабельное зенитное орудие

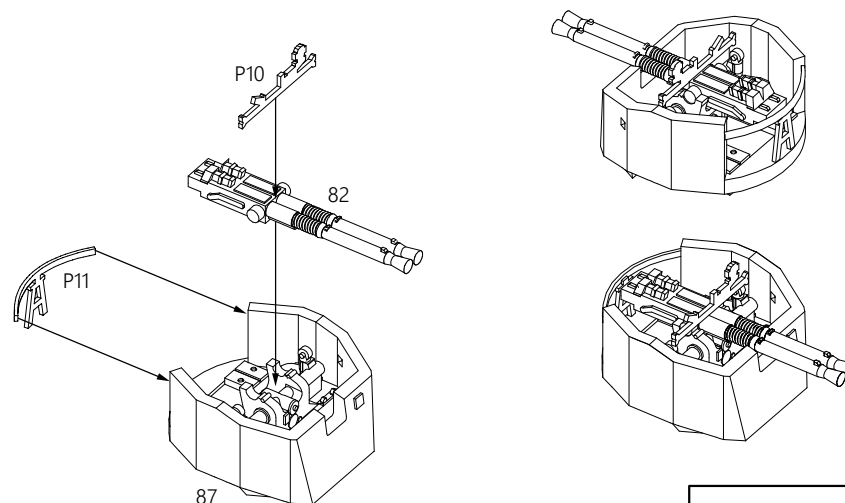

16x

Стабилизированный пост наводки СПН-500

A4

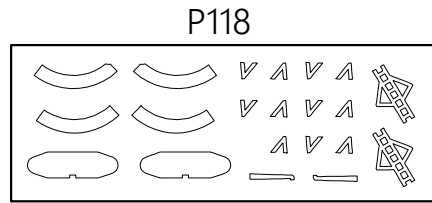
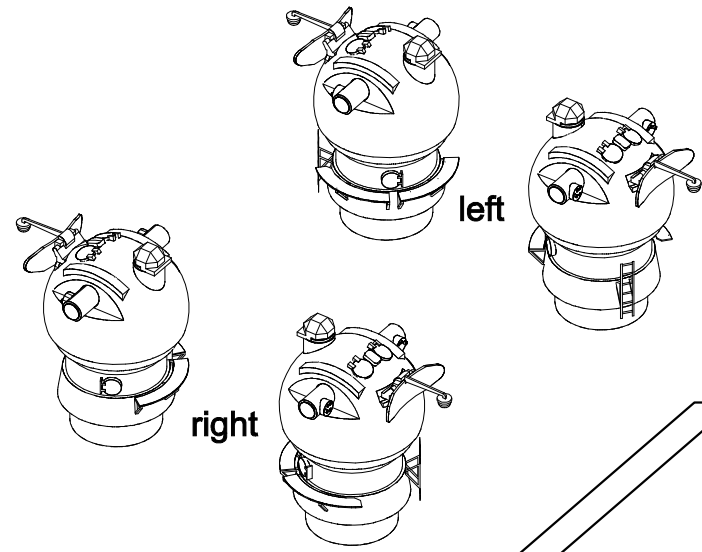
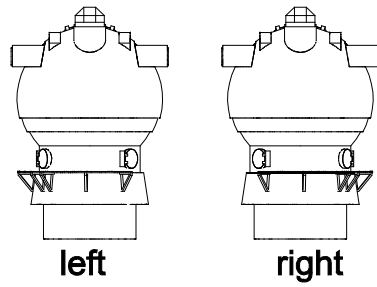
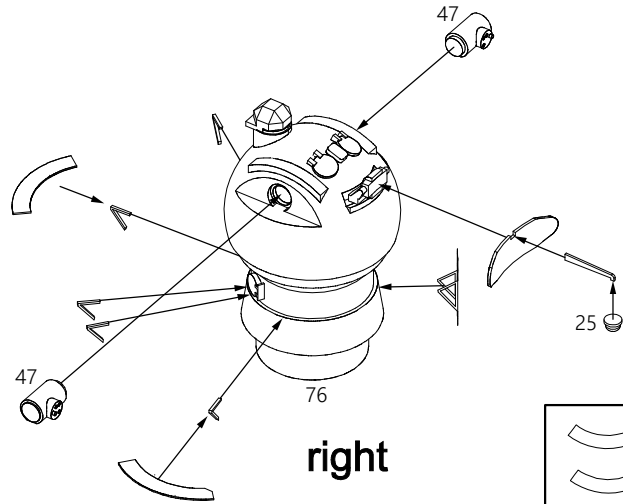

2x (1x left+1x right)

A5

Командно-дальномерный пост КПД₂-8

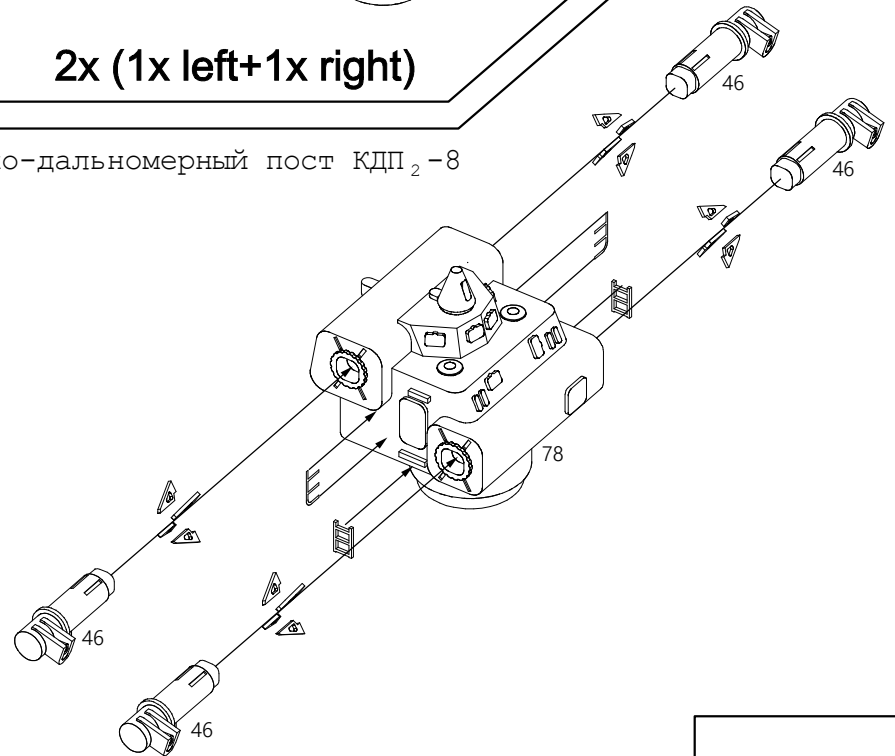
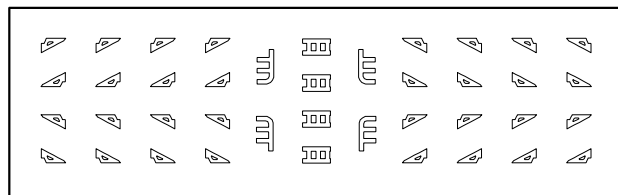
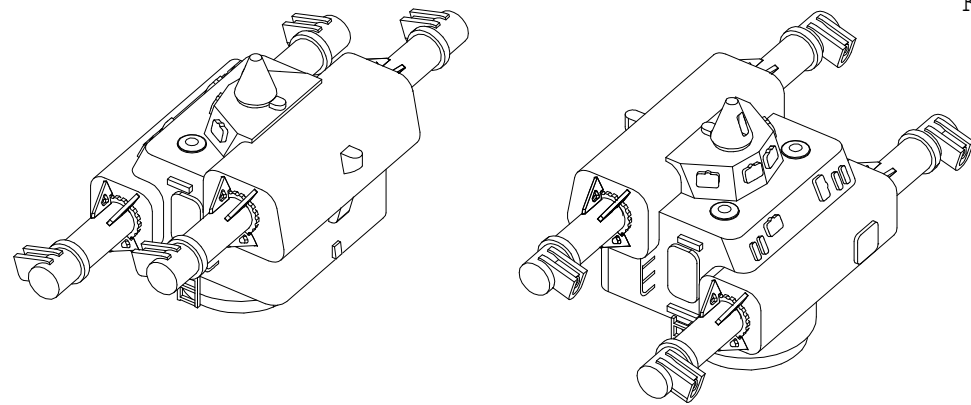

2x



A9

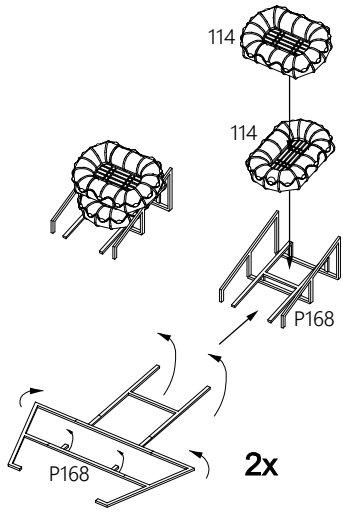

A10

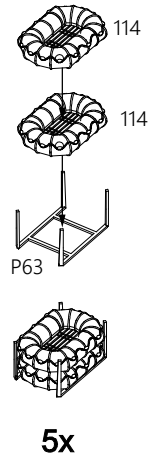

A11

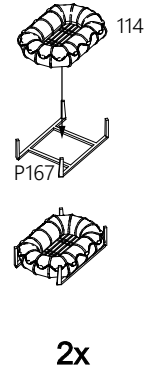

A12

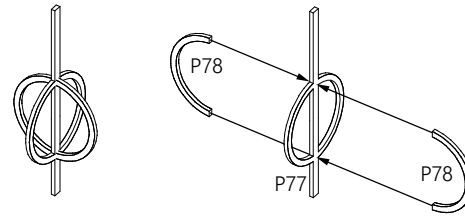

A14

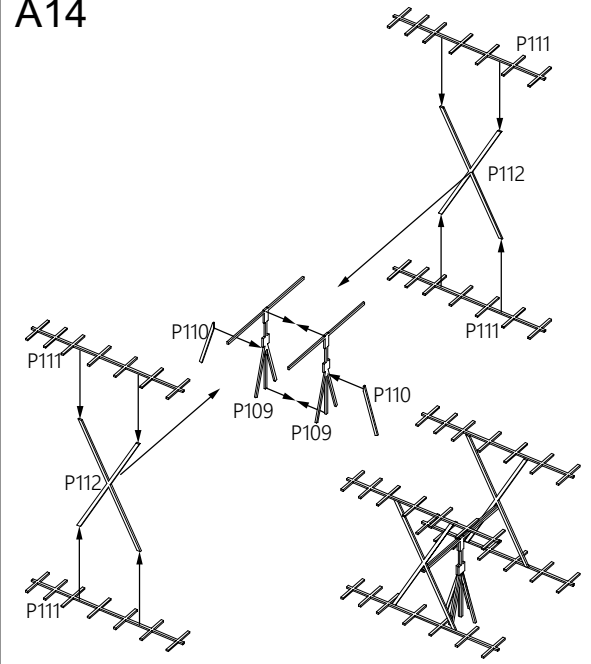

A13

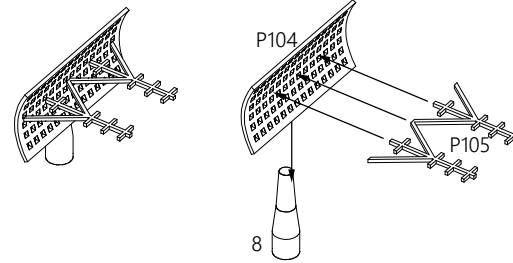

A8

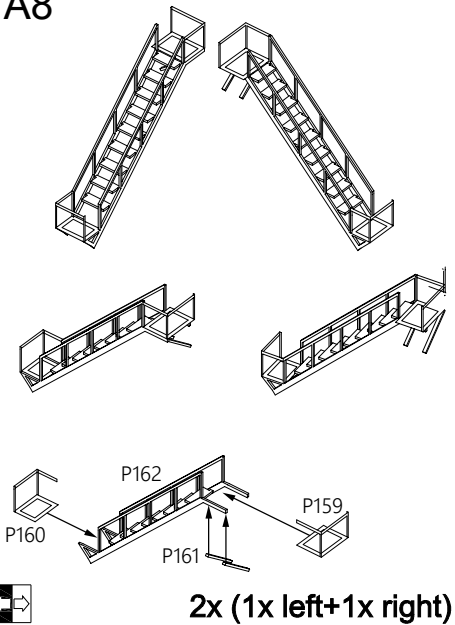

A6

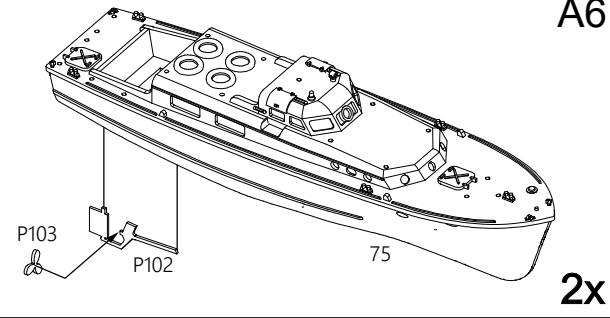

A7

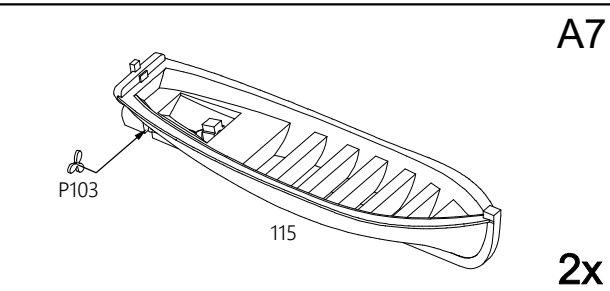

A15

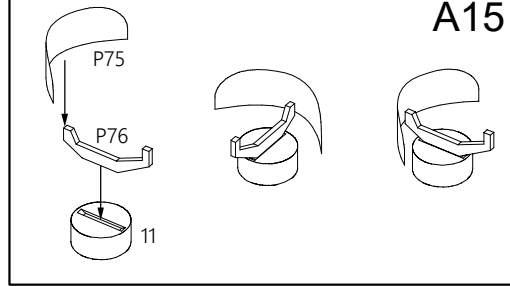

A16

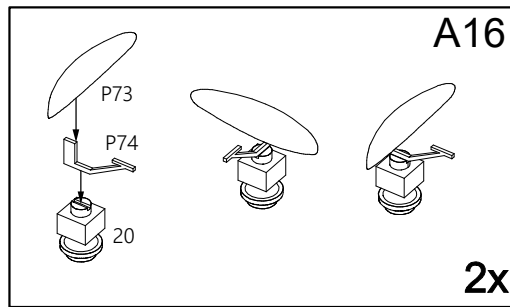

A17

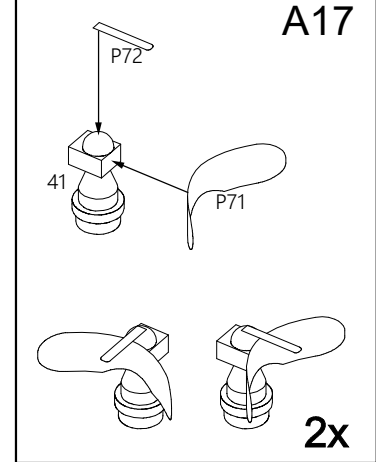

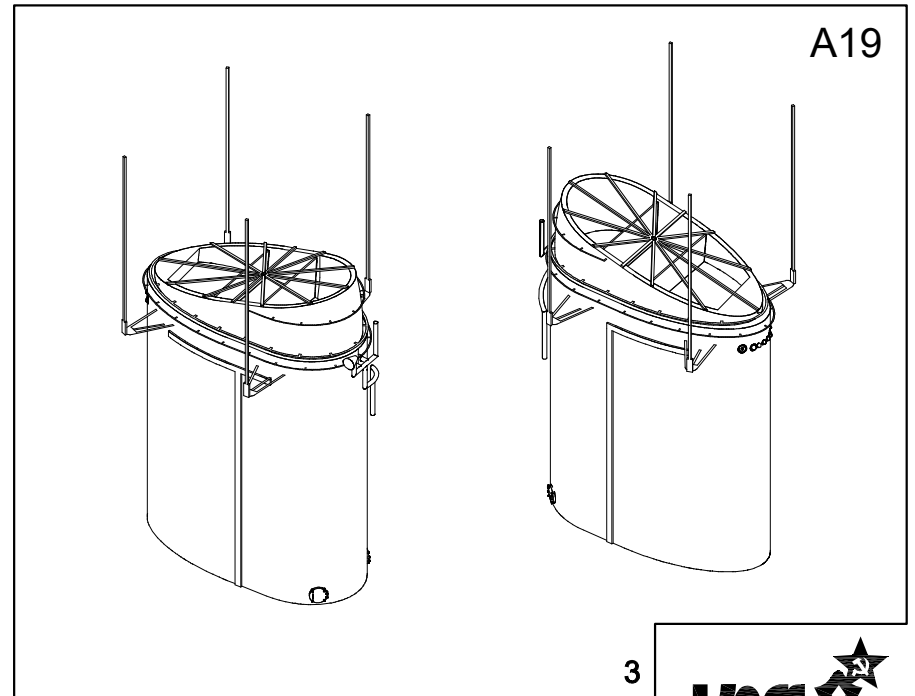
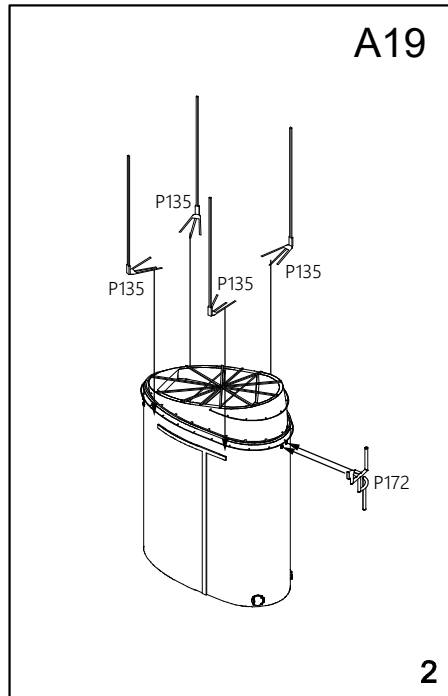
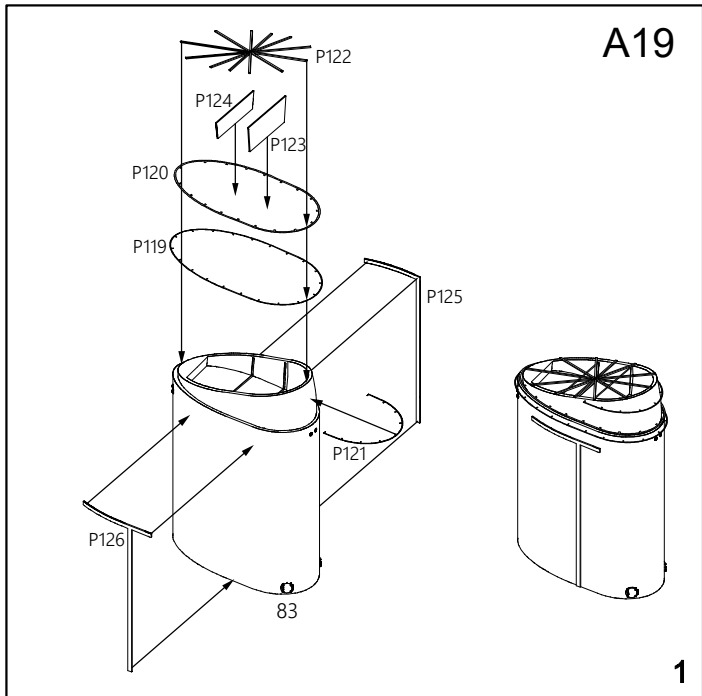
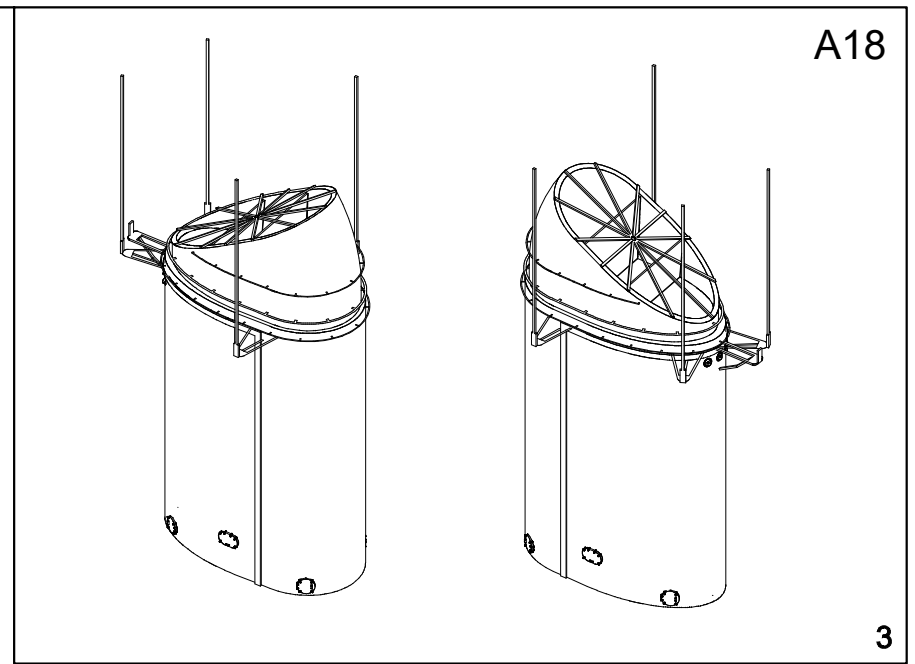
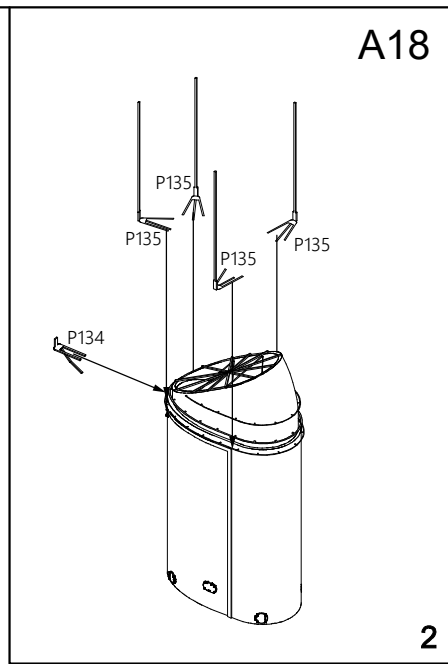
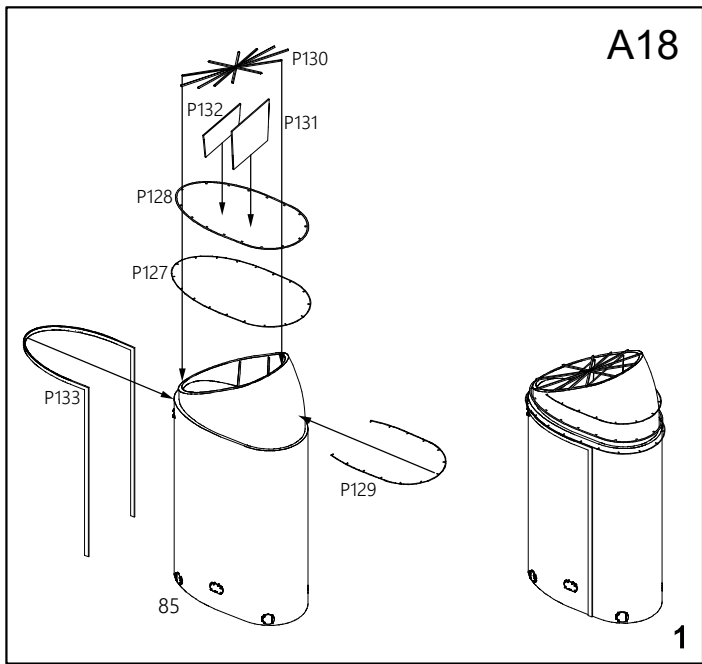

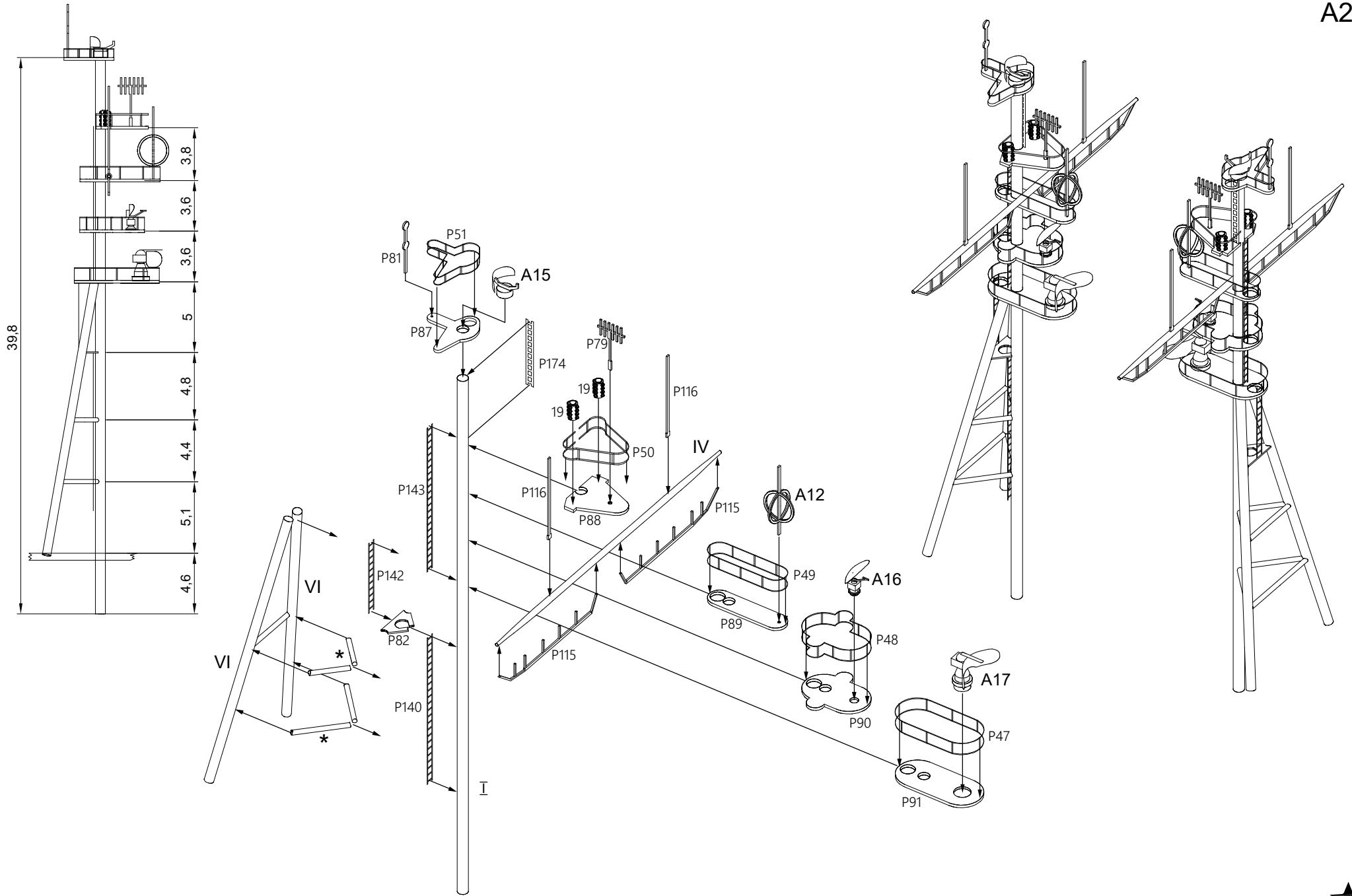

* - self made parts Ø 0.3mm

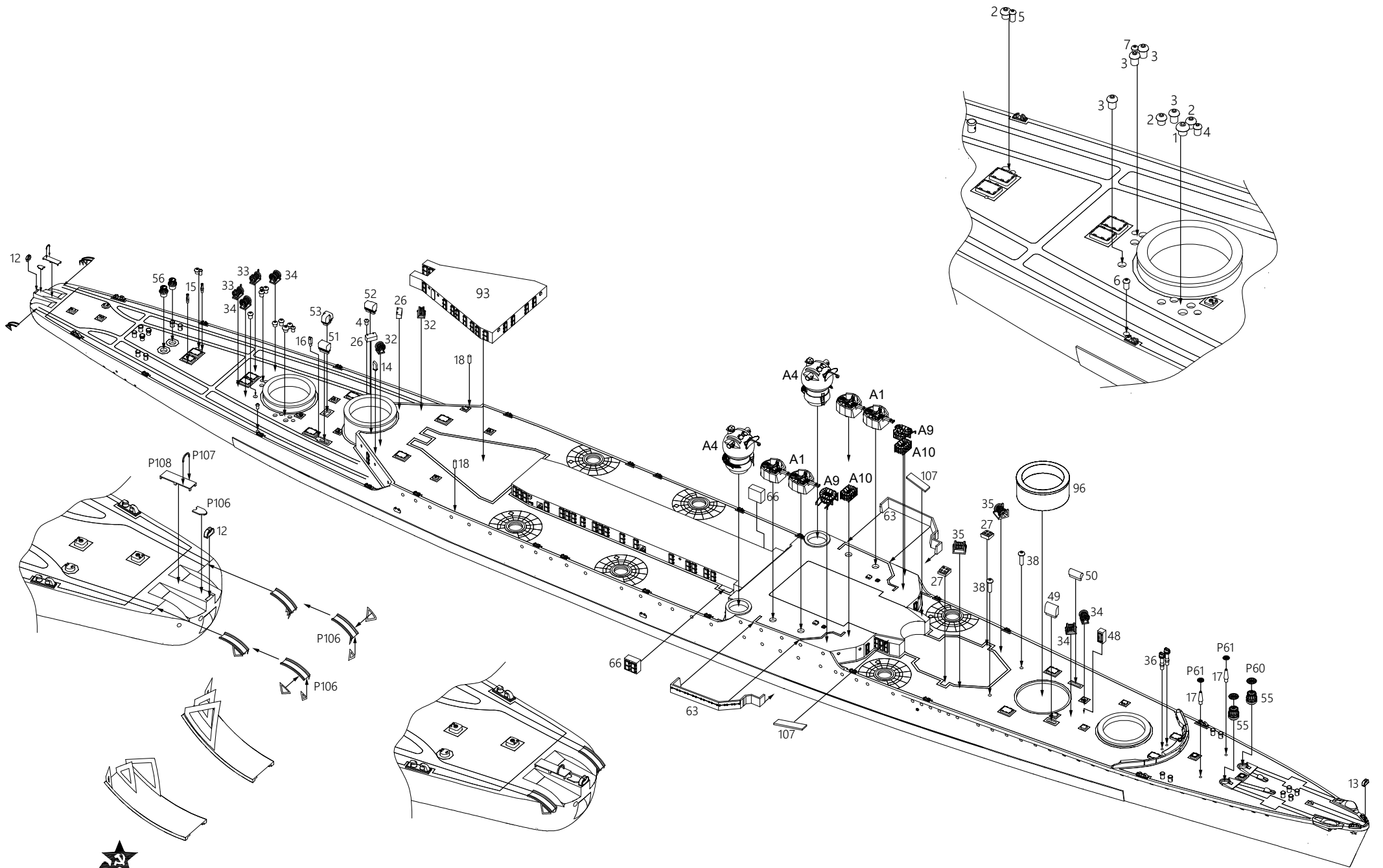

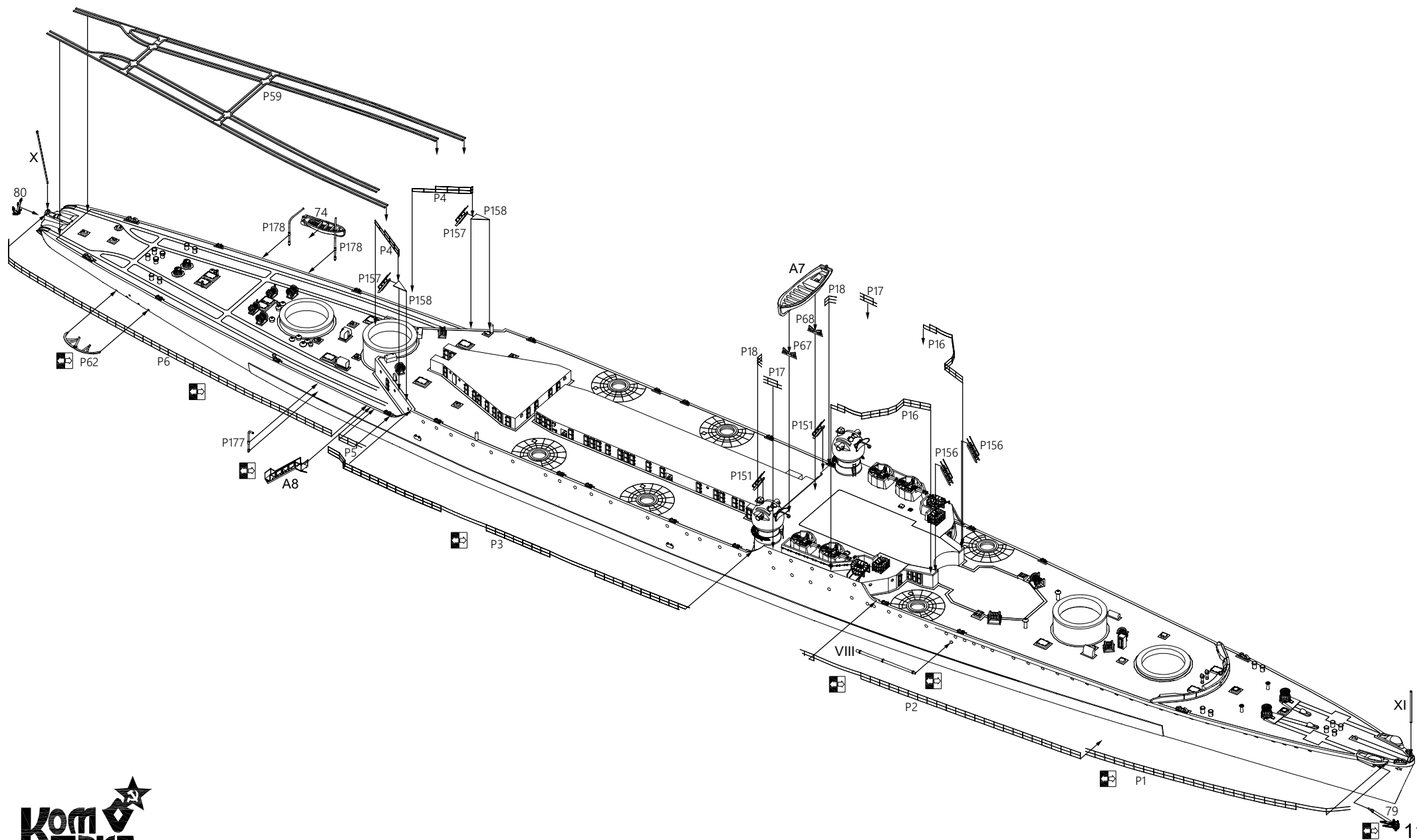

A22

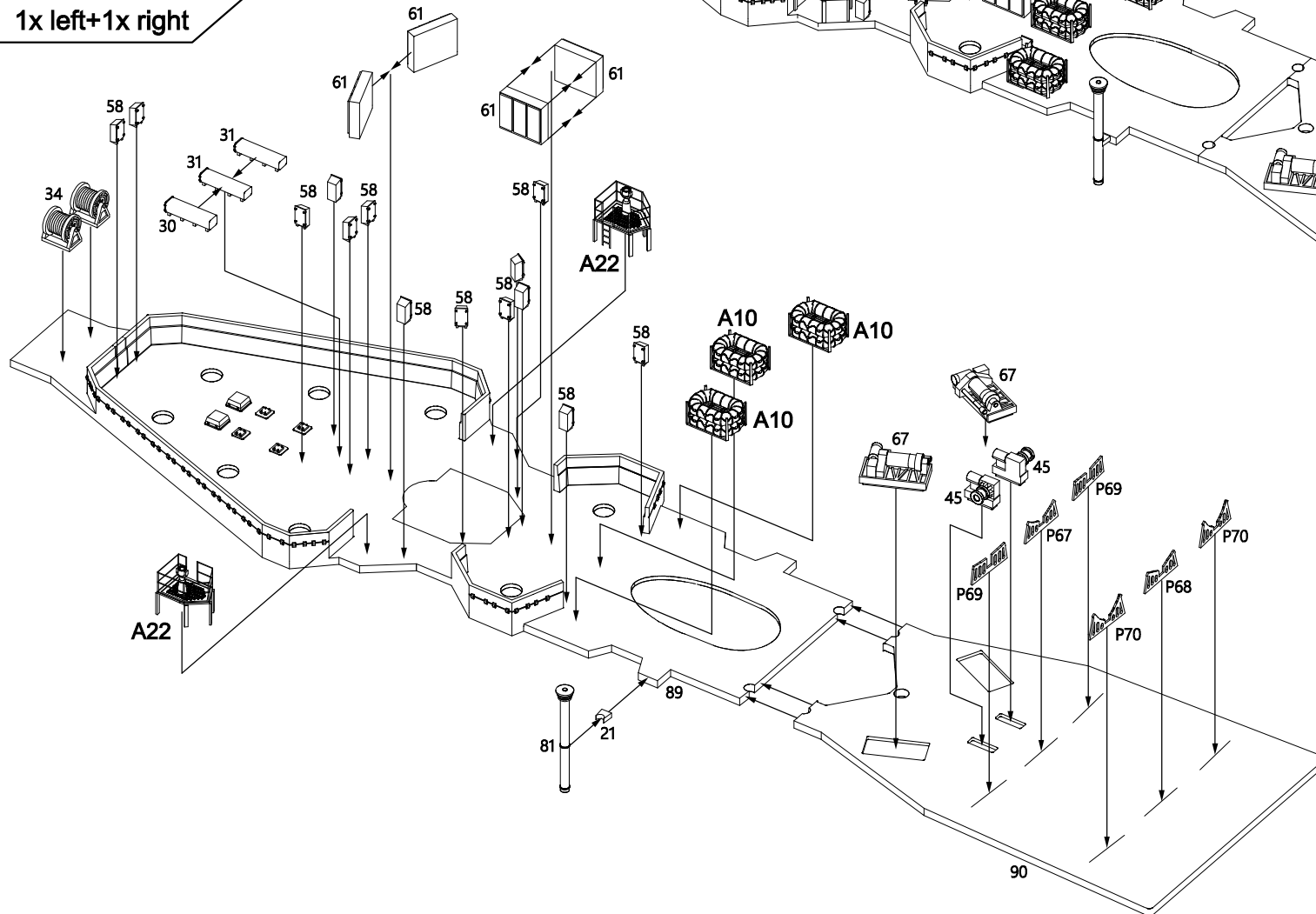
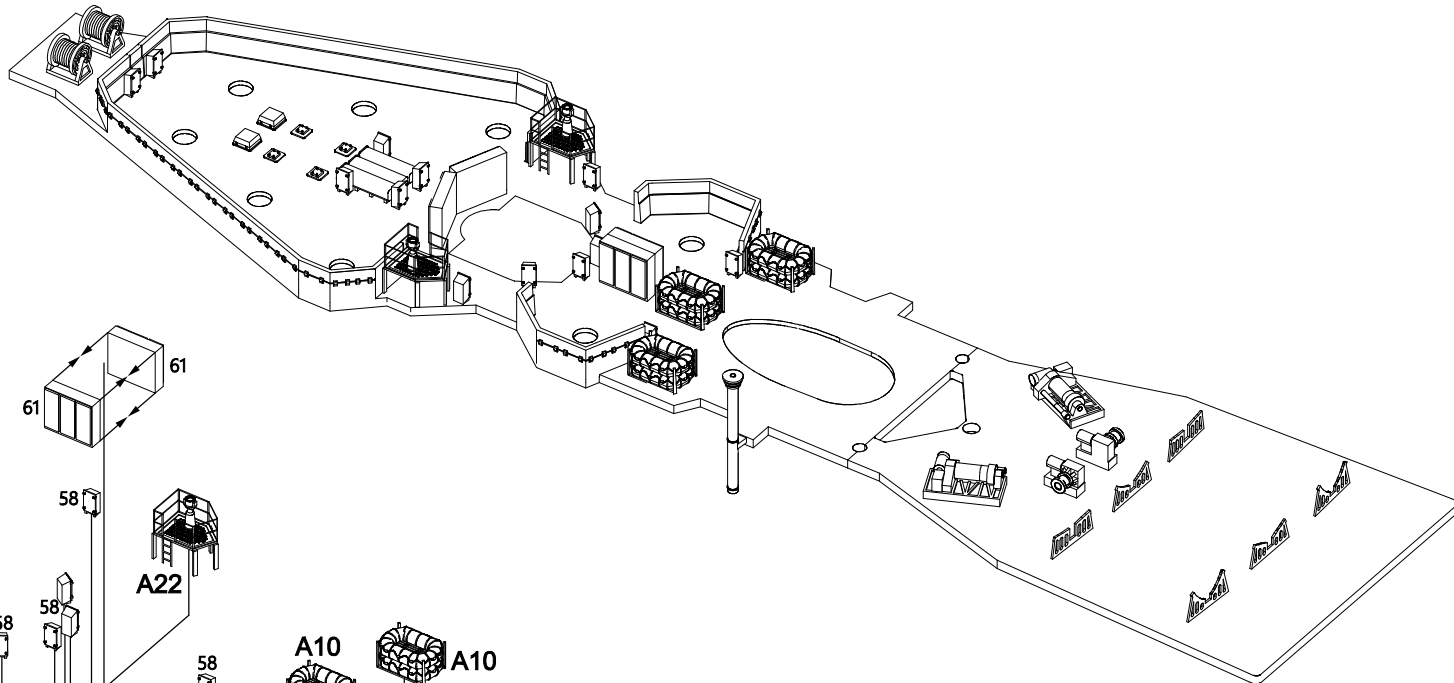
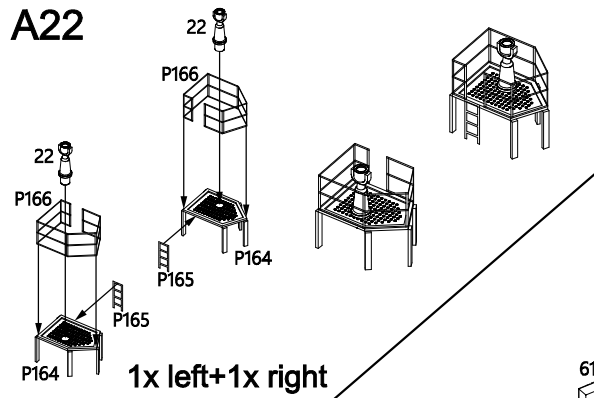

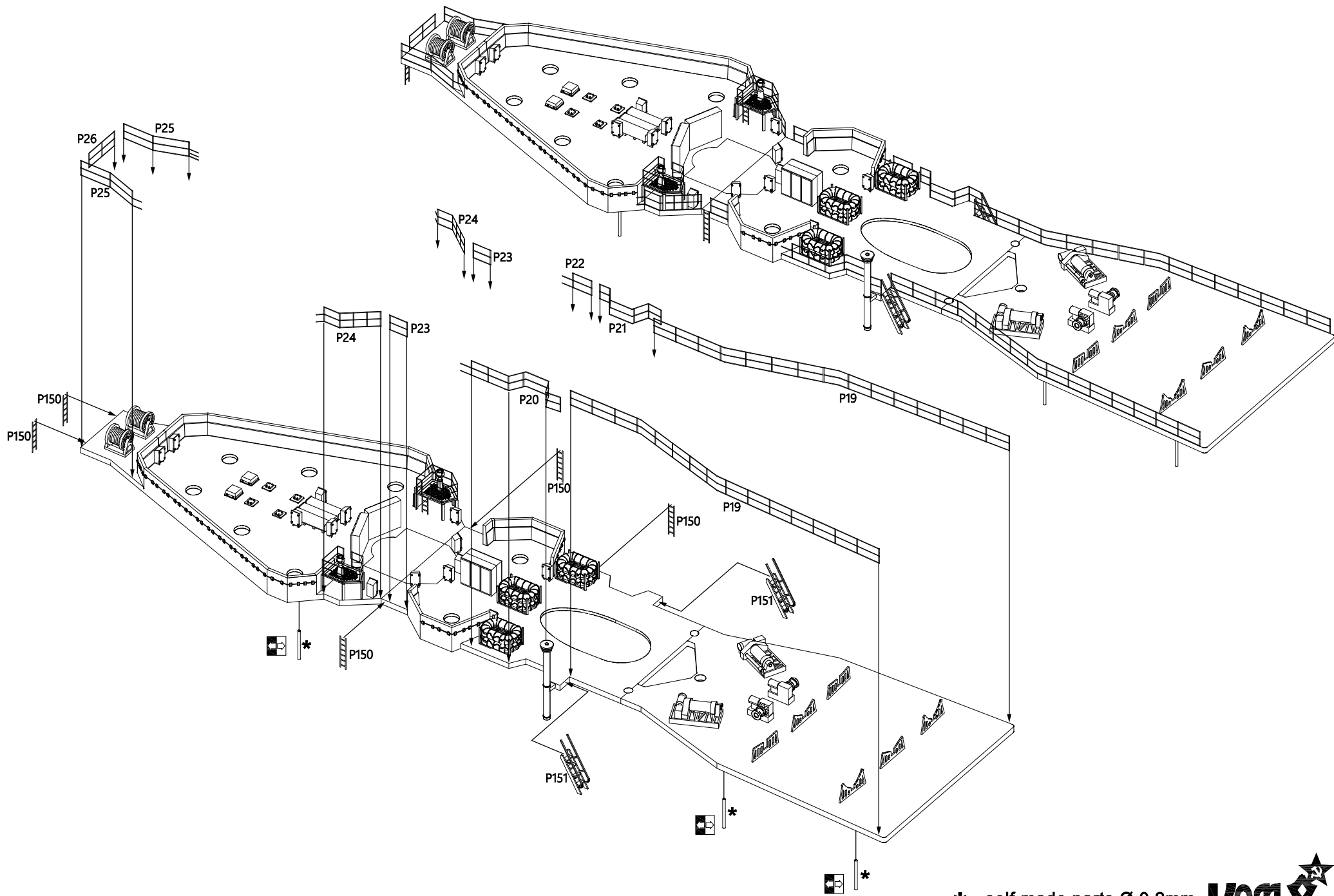

* - self made parts Ø 0.2mm

A23

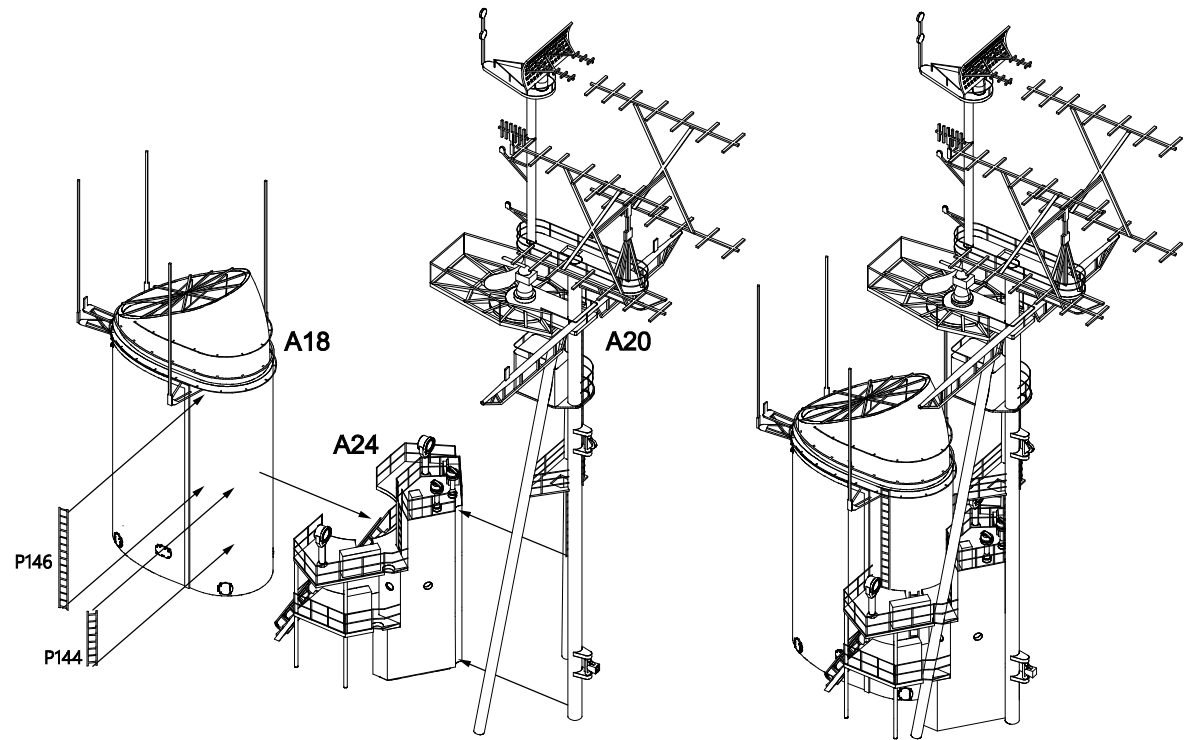
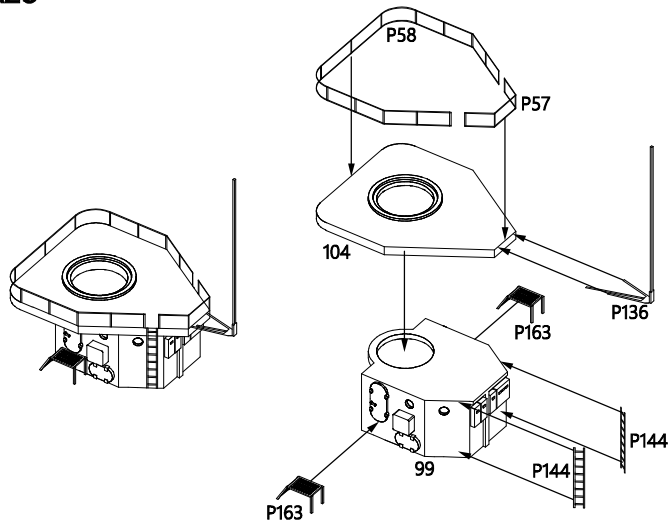

A24

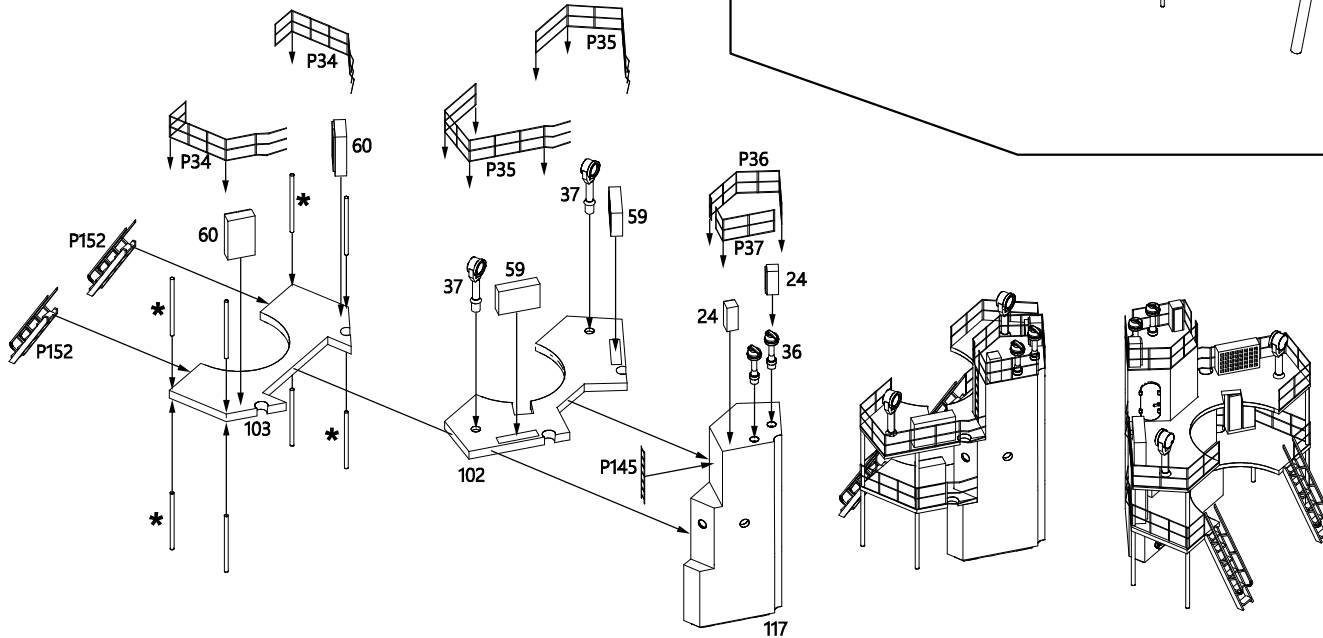

* - self made parts Ø 0.2mm

A25

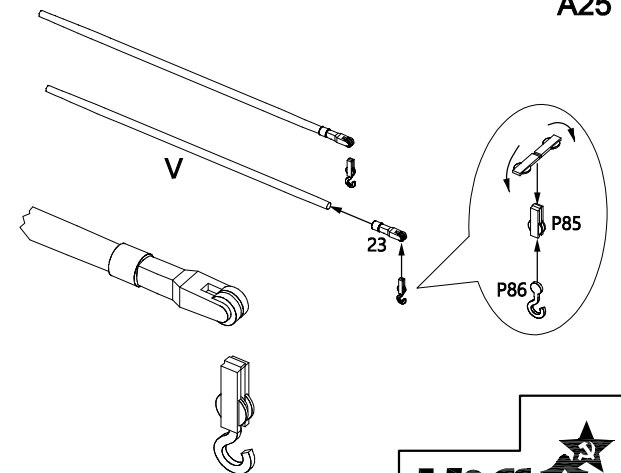

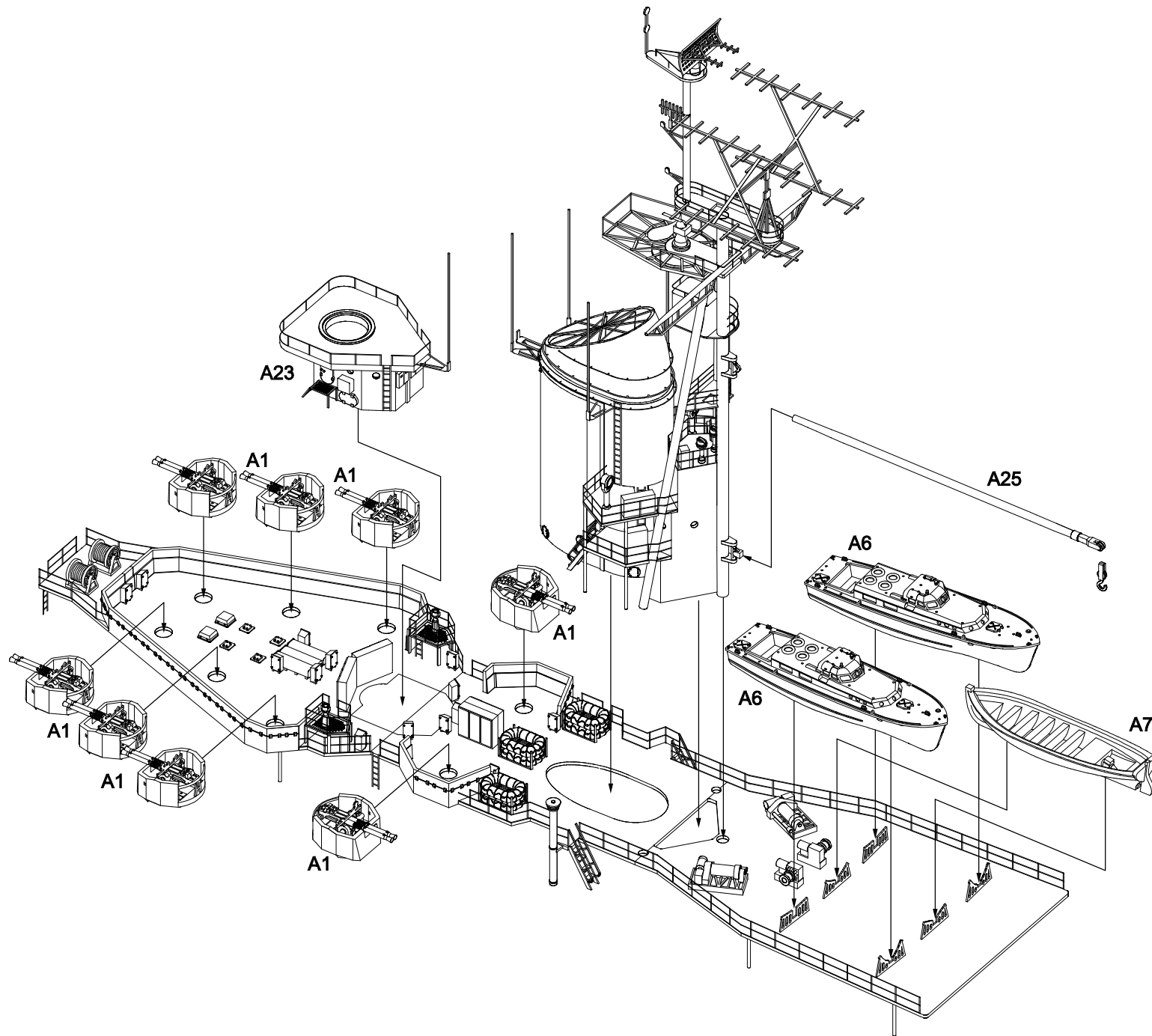

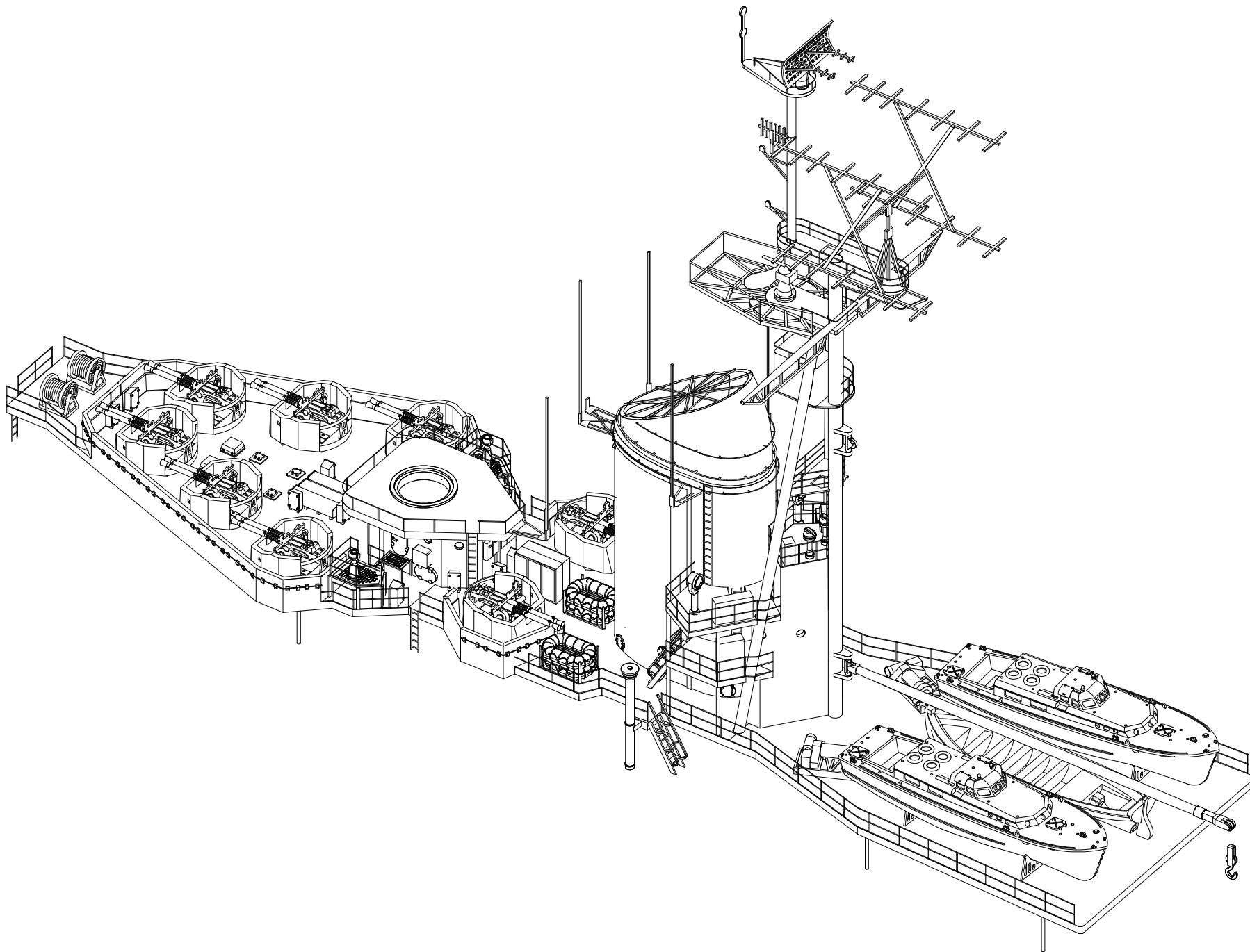

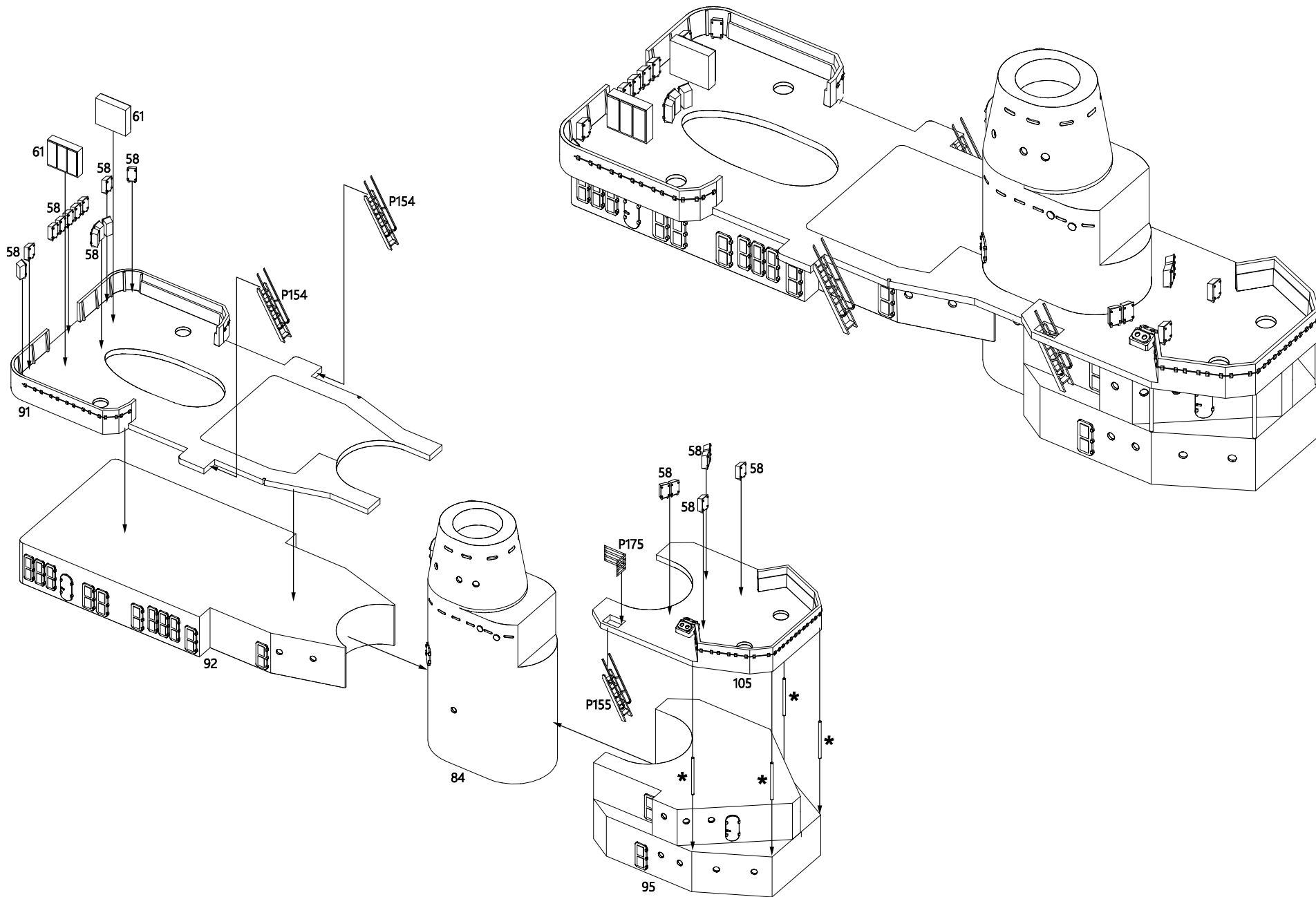

* - self made parts Ø 0.2mm

70317 For more info on Combrig kits see: www.combrig-models.com www.steelnavy.net www.modelwarships.com

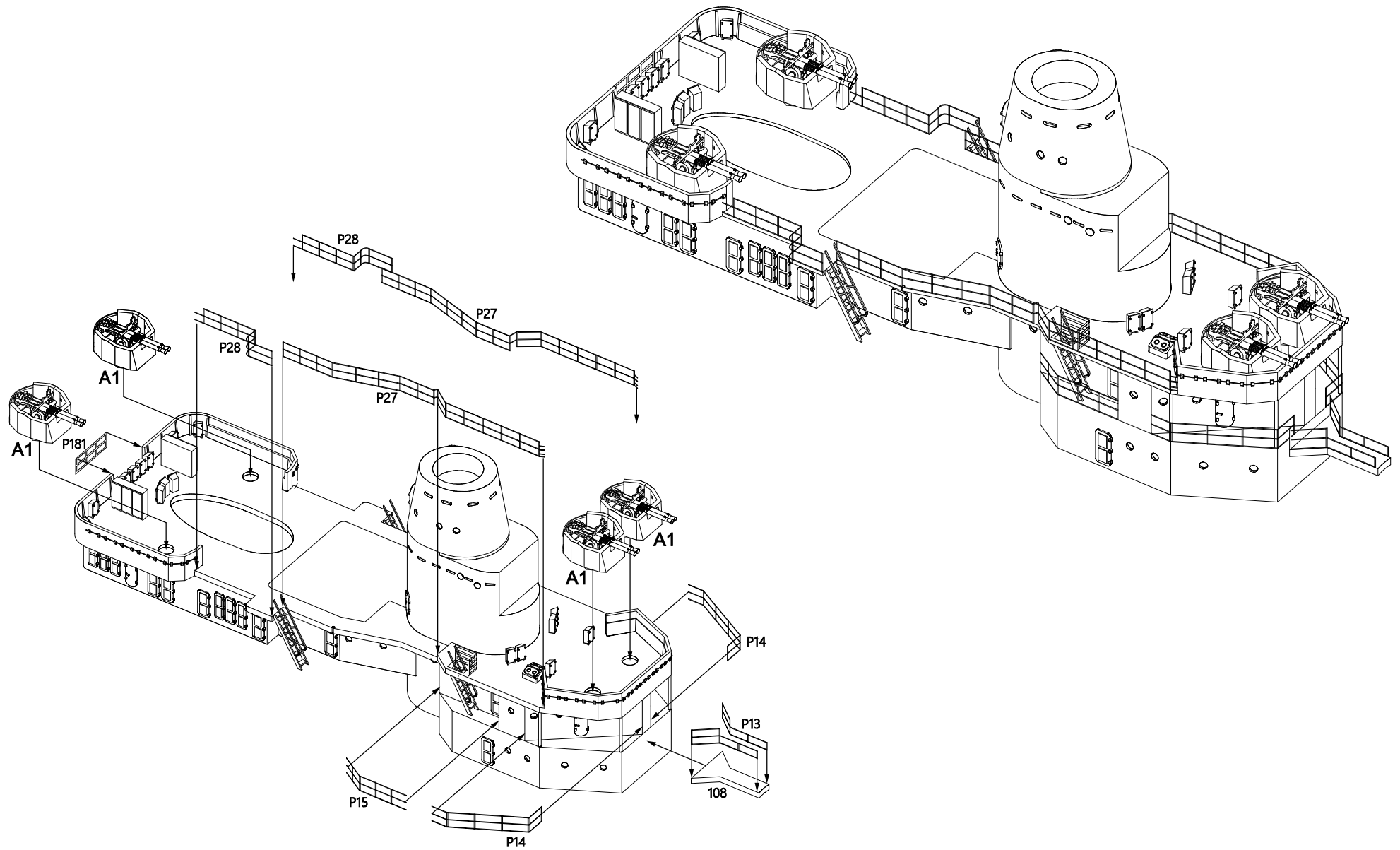

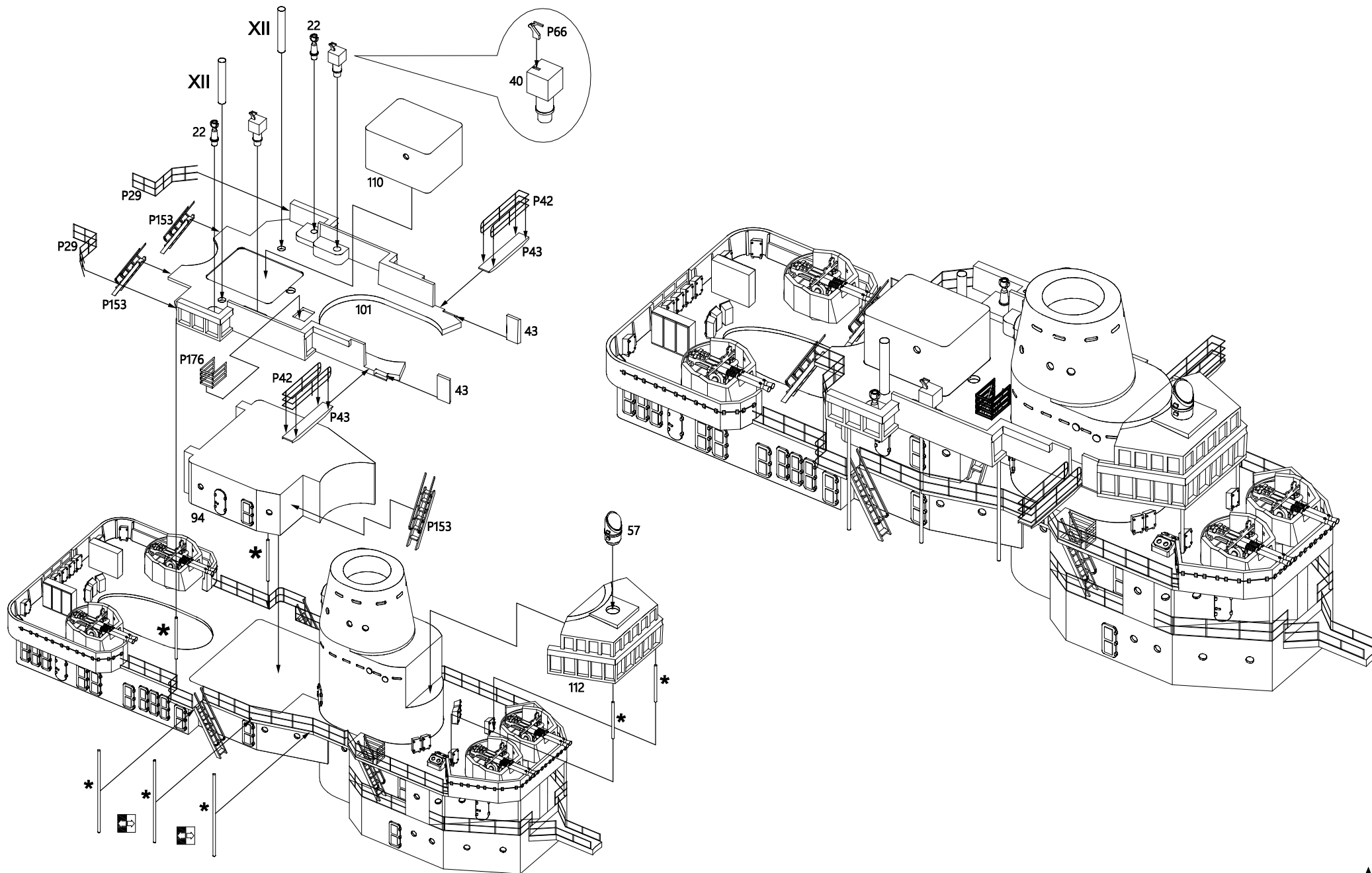

* - self made parts Ø 0.2mm

A26

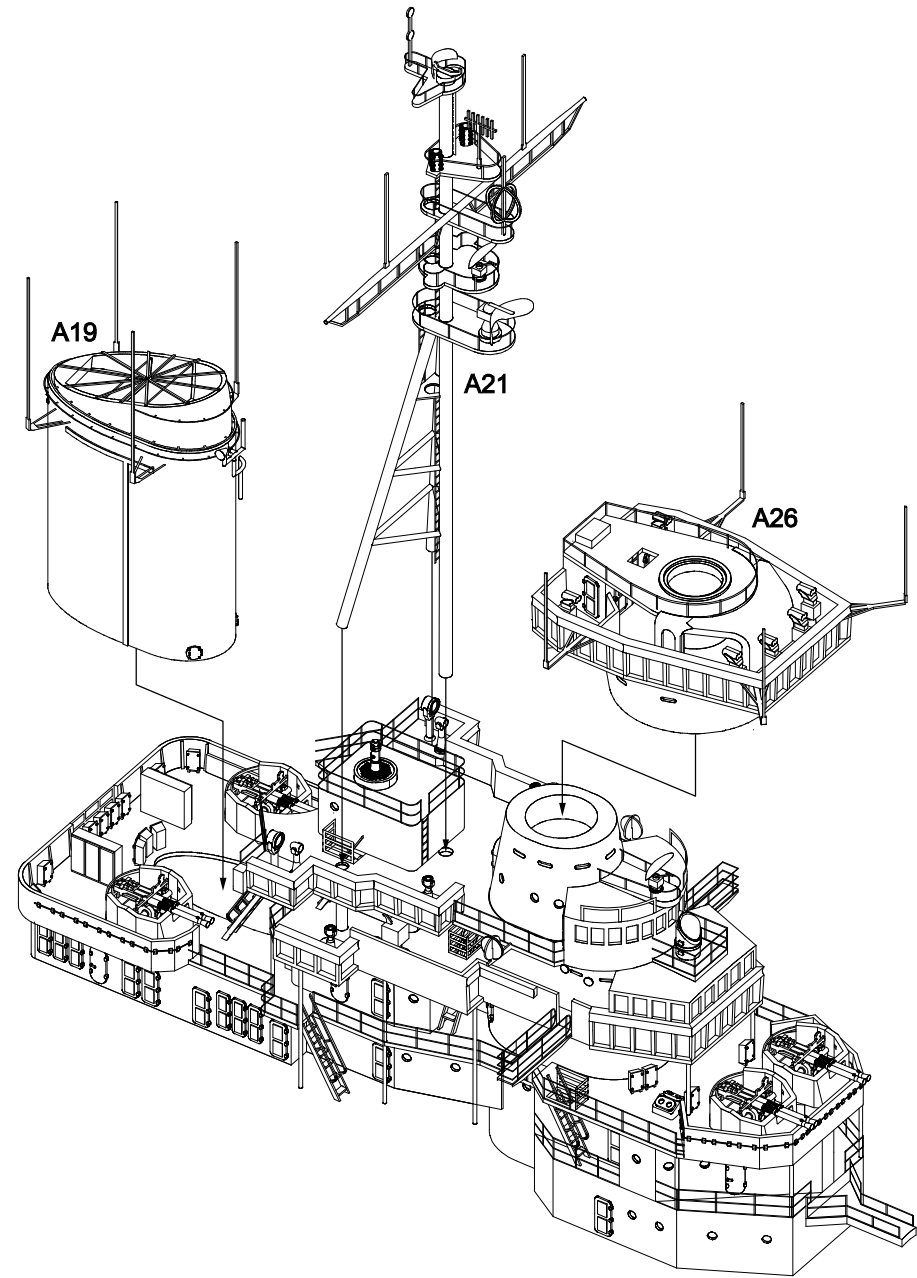
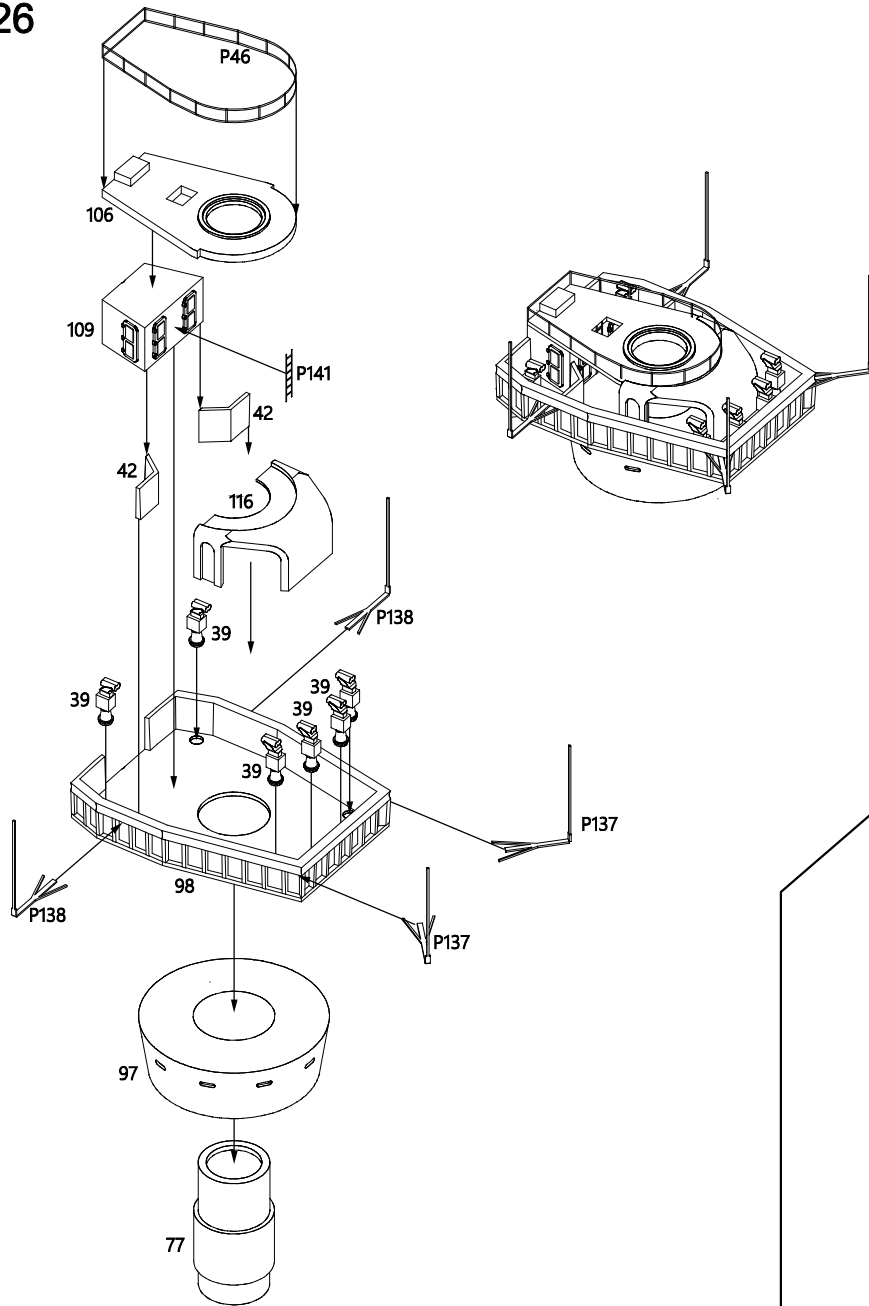

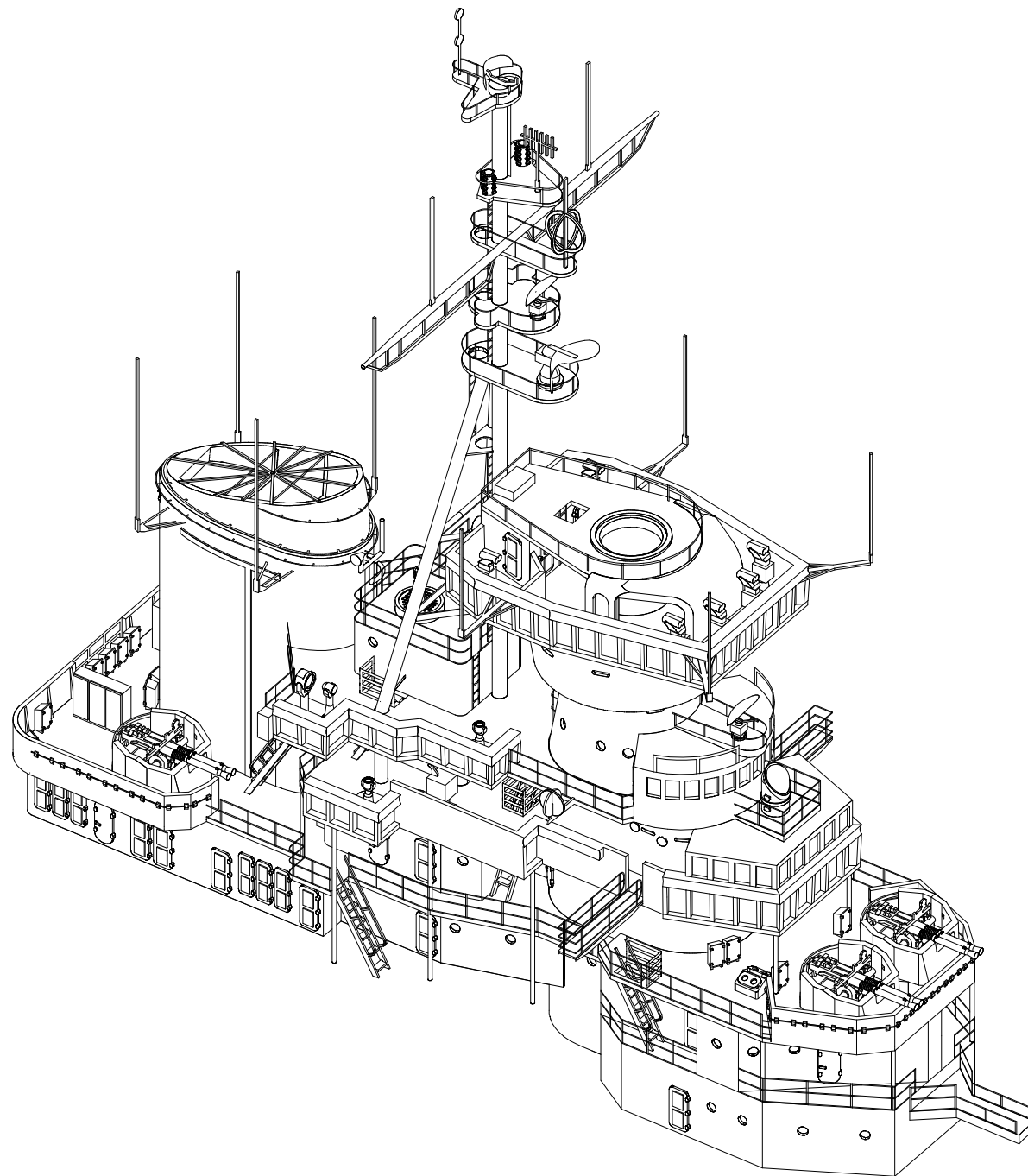

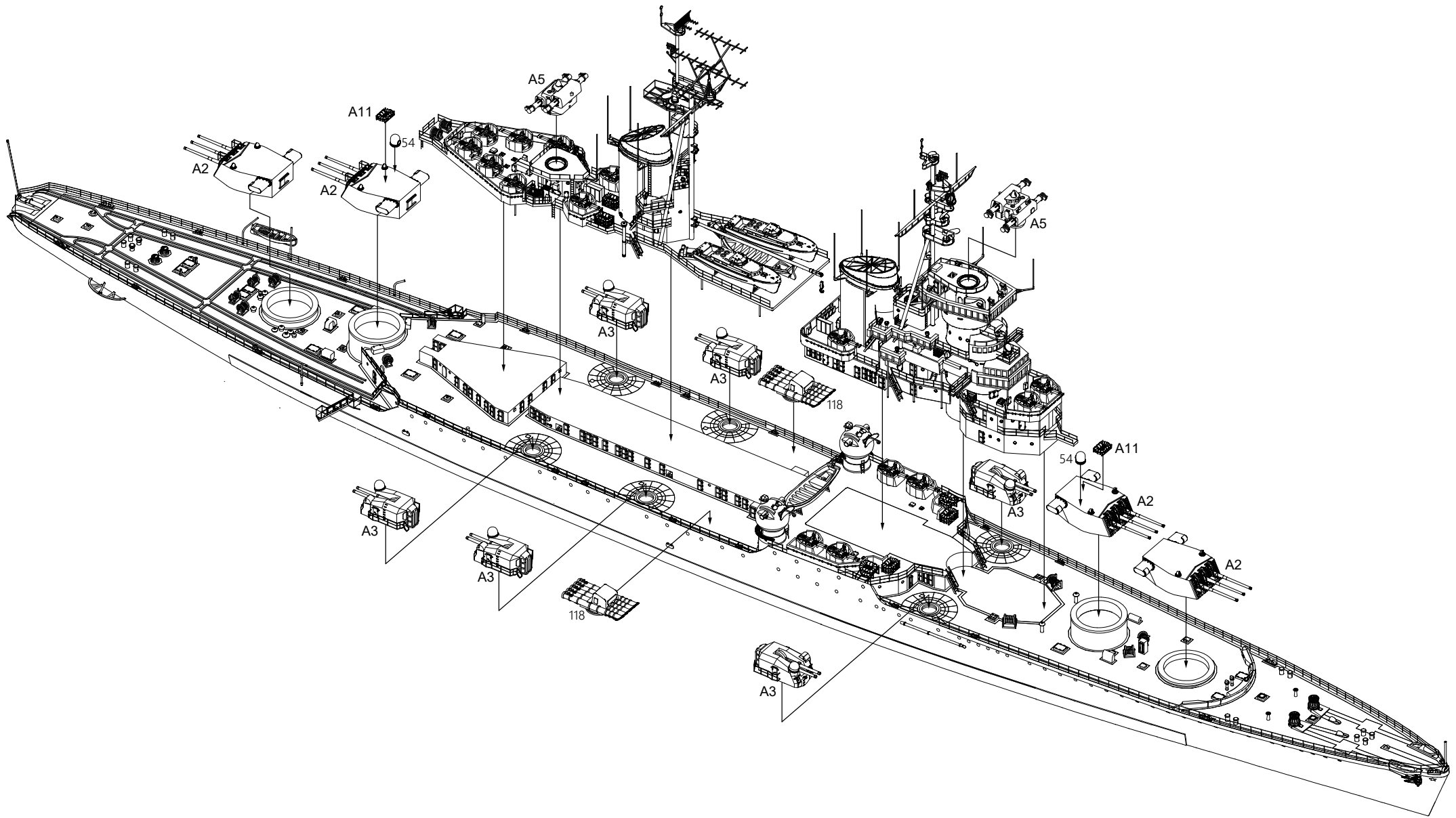

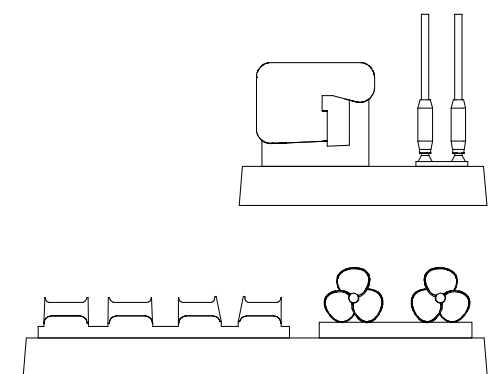
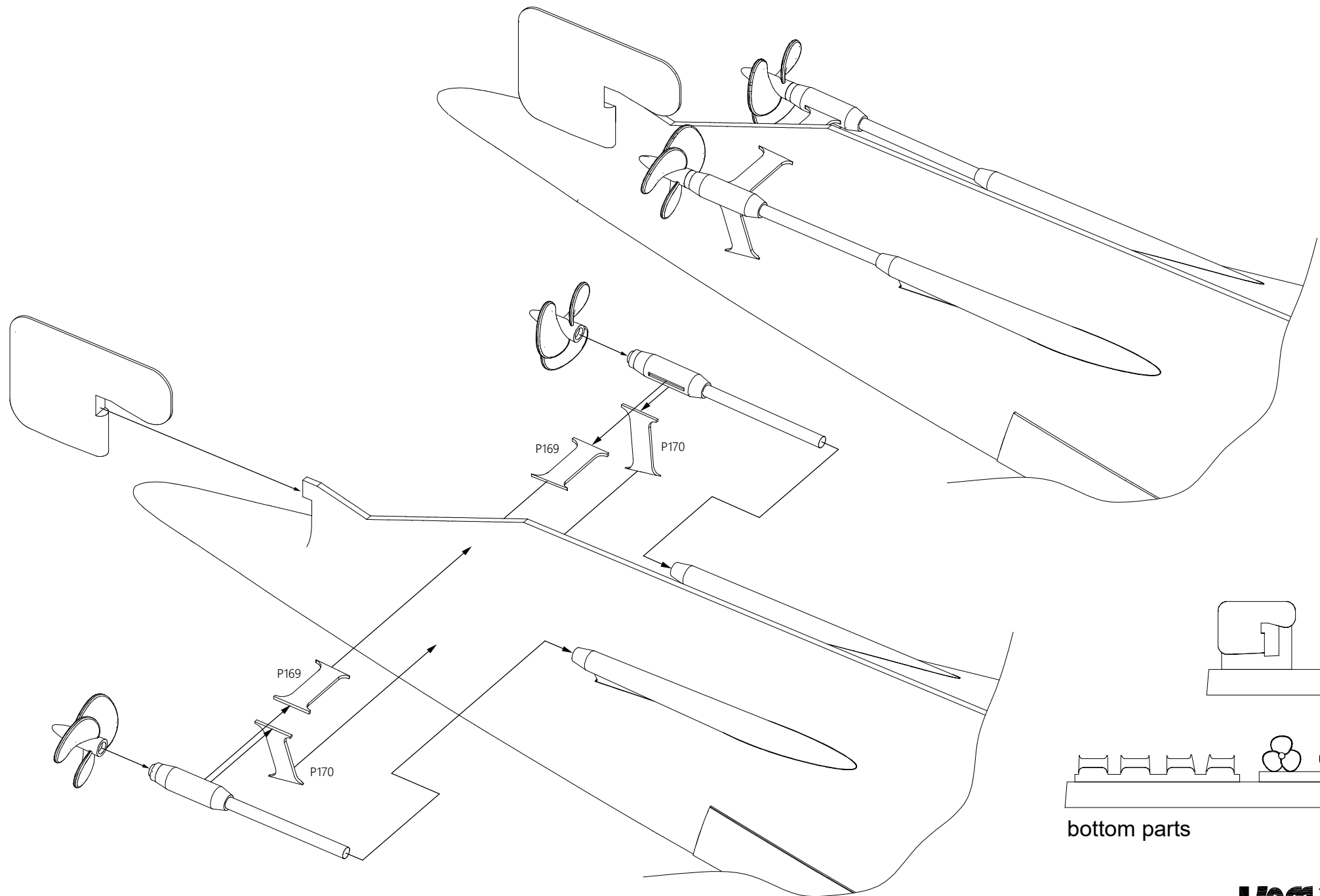

bottom parts