

HMS Battleship, 1910

COLOSSUS

КОЛОСУС линейный корабль

Великобритания, 1910

1:700

Displacement: 20,030 tons
Length:..... 166.3 m
Beam:..... 26.4 m
Draught:..... 8.2 m
Installed power: 25,000 ihp

Propulsion: 4 x shafts; 2 x steam turbine sets
18 x Babcock & Wilcox boilers
Speed:.....21 knots
Complement: 751

Armament:
5 x twin 12-inch (305 mm) guns
16 x single 4-inch (102 mm) guns
3 x 18-inch (450 mm) torpedo tubes

Armour:
Belt: 8–11 in (203–279 mm)
Bulkheads: 4 and 8 in (102 and 203 mm)
Deck: 1.5–4 inches (32–76 mm)
Conning tower: 11 in (280 mm)
Turrets: 11 in (280 mm)
Barbettes: 4–11 inches (102–279 mm)

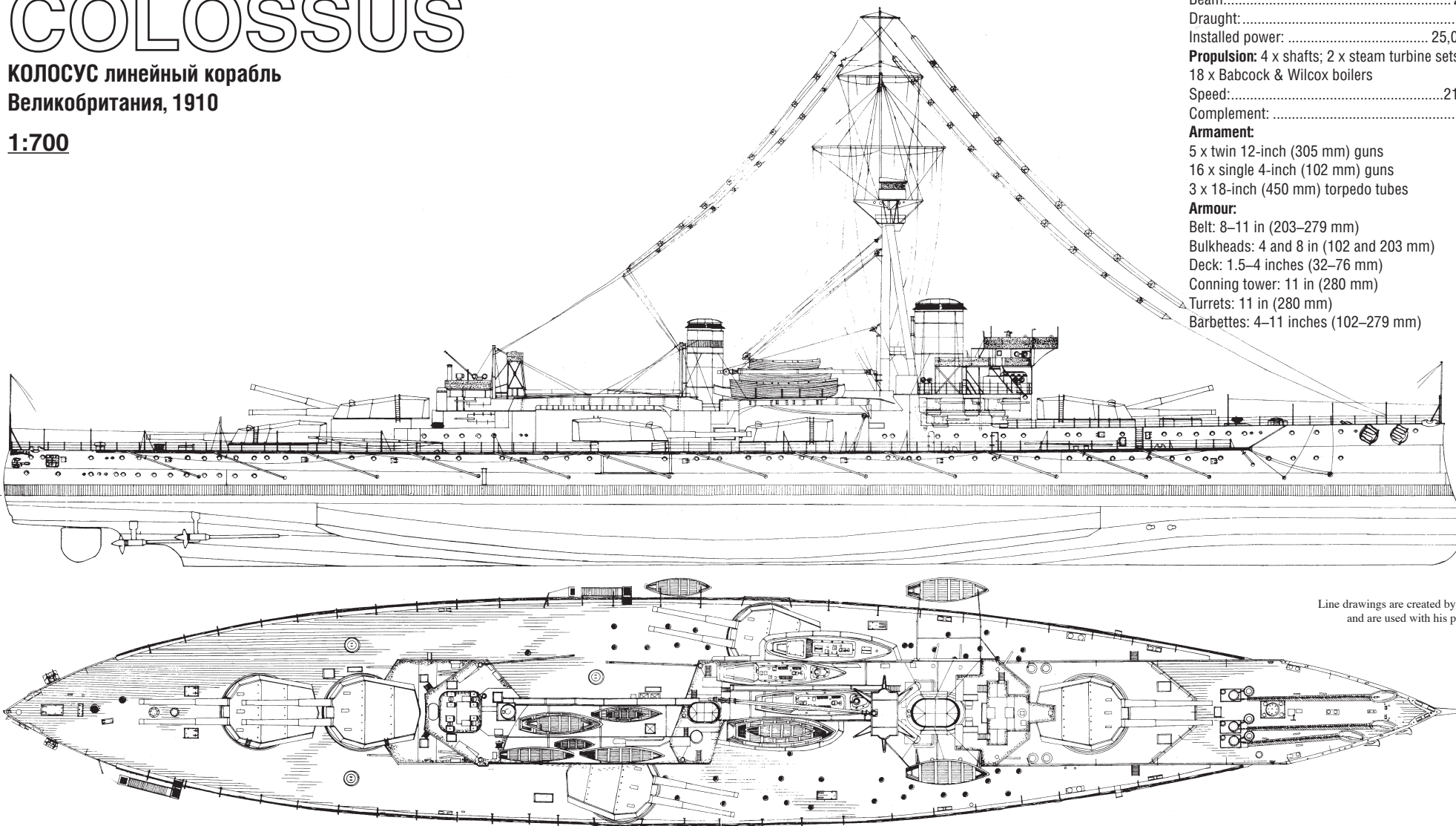

Line drawings are created by R.A. Burt and are used with his permission.

HMS Colossus was the lead ship of her class of two dreadnought battleships built for the Royal Navy at the end of the first decade of the 20th century. She spent her whole career assigned to the Home and Grand Fleets, often serving as a flagship. Aside

from participating in the Battle of Jutland in May 1916 and the inconclusive Action of 19 August, her service during World War I generally consisted of routine patrols and training in the North Sea. Colossus was the only dreadnought from the main body of

the Grand Fleet to be hit during the Battle of Jutland, although she suffered only minor damage. The ship was deemed obsolete after the war and was reduced to reserve and then became a training ship. Colossus was hulked in 1923 and sold for scrap in 1928.

70628 For more info on Combrig kits see: www.combrig-models.com www.steelnavy.net www.modelwarships.com

**Ком
Бриг**
Made in Russia

СХЕМА СБОРКИ МОДЕЛИ
ASSEMBLY INSTRUCTIONS

1

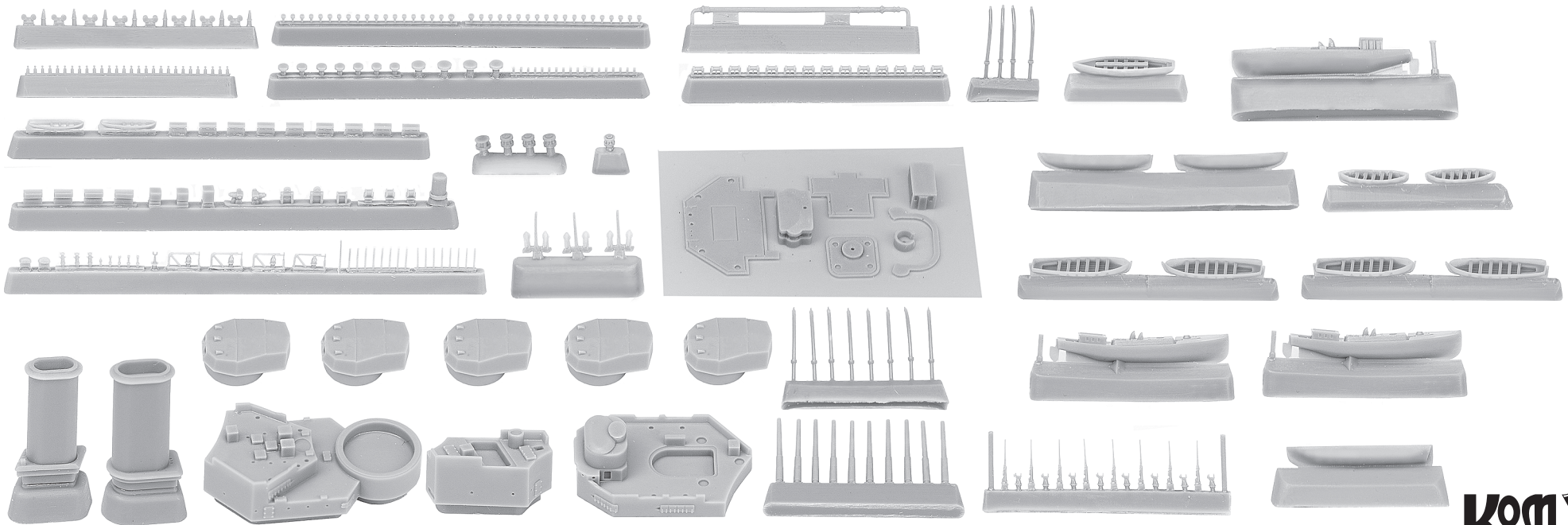
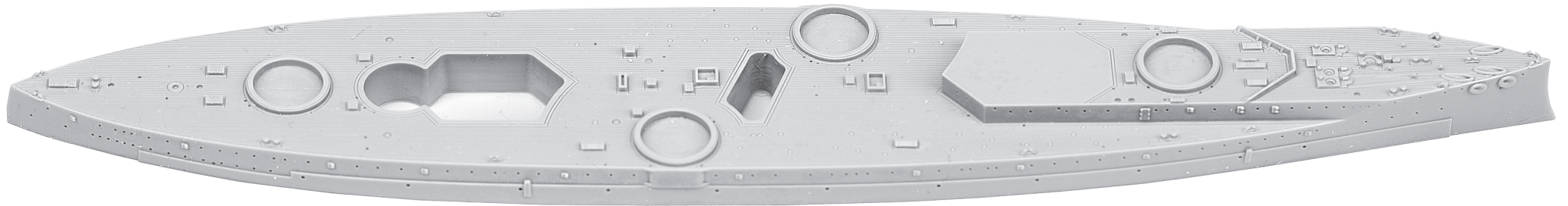

70628 For more info on Combrig kits see: www.combrig-models.com www.steelnavy.net www.modelwarships.com



СХЕМА СБОРКИ МОДЕЛИ
ASSEMBLY INSTRUCTIONS

2

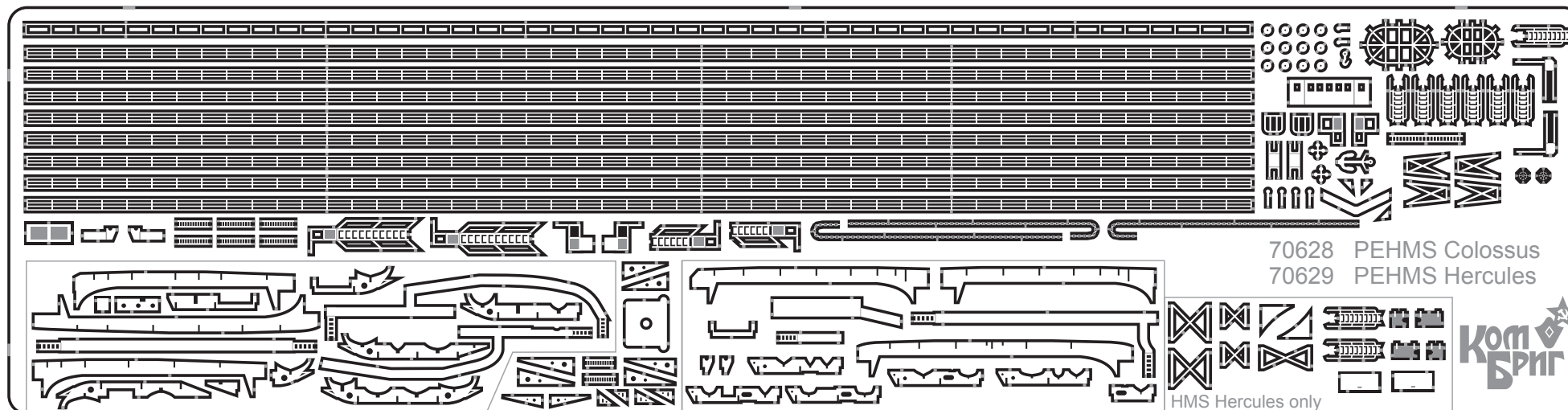

70628 PEHMS Colossus
70629 PEHMS Hercules

HMS Hercules only



СХЕМА СБОРКИ МОДЕЛИ
ASSEMBLY INSTRUCTIONS

3

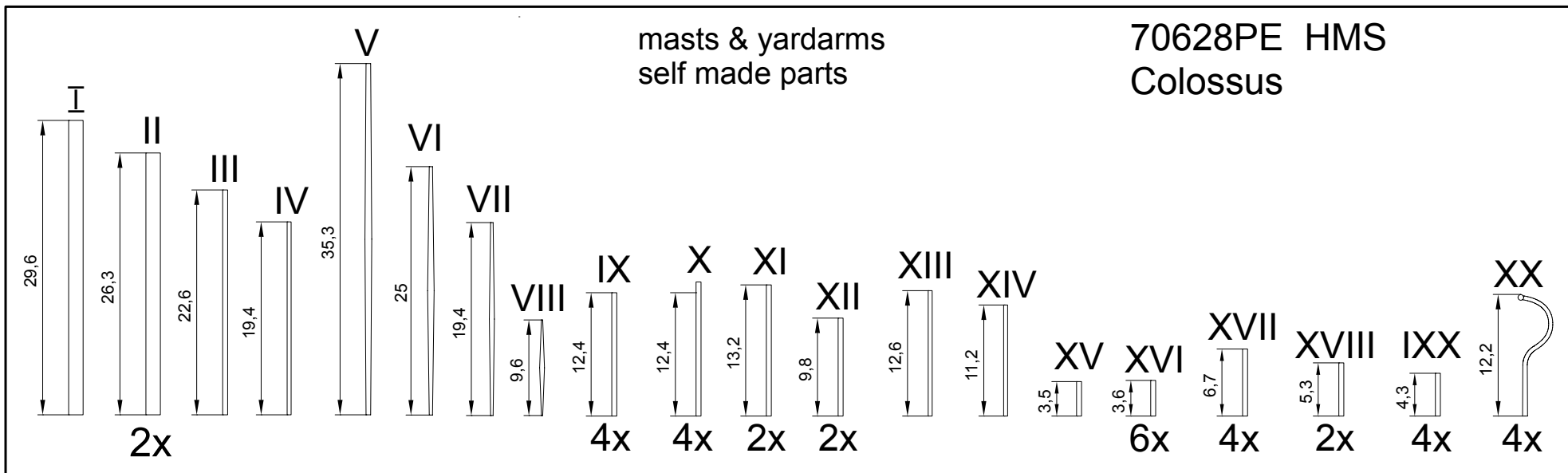

СХЕМА СБОРКИ МОДЕЛИ
ASSEMBLY INSTRUCTIONS

4

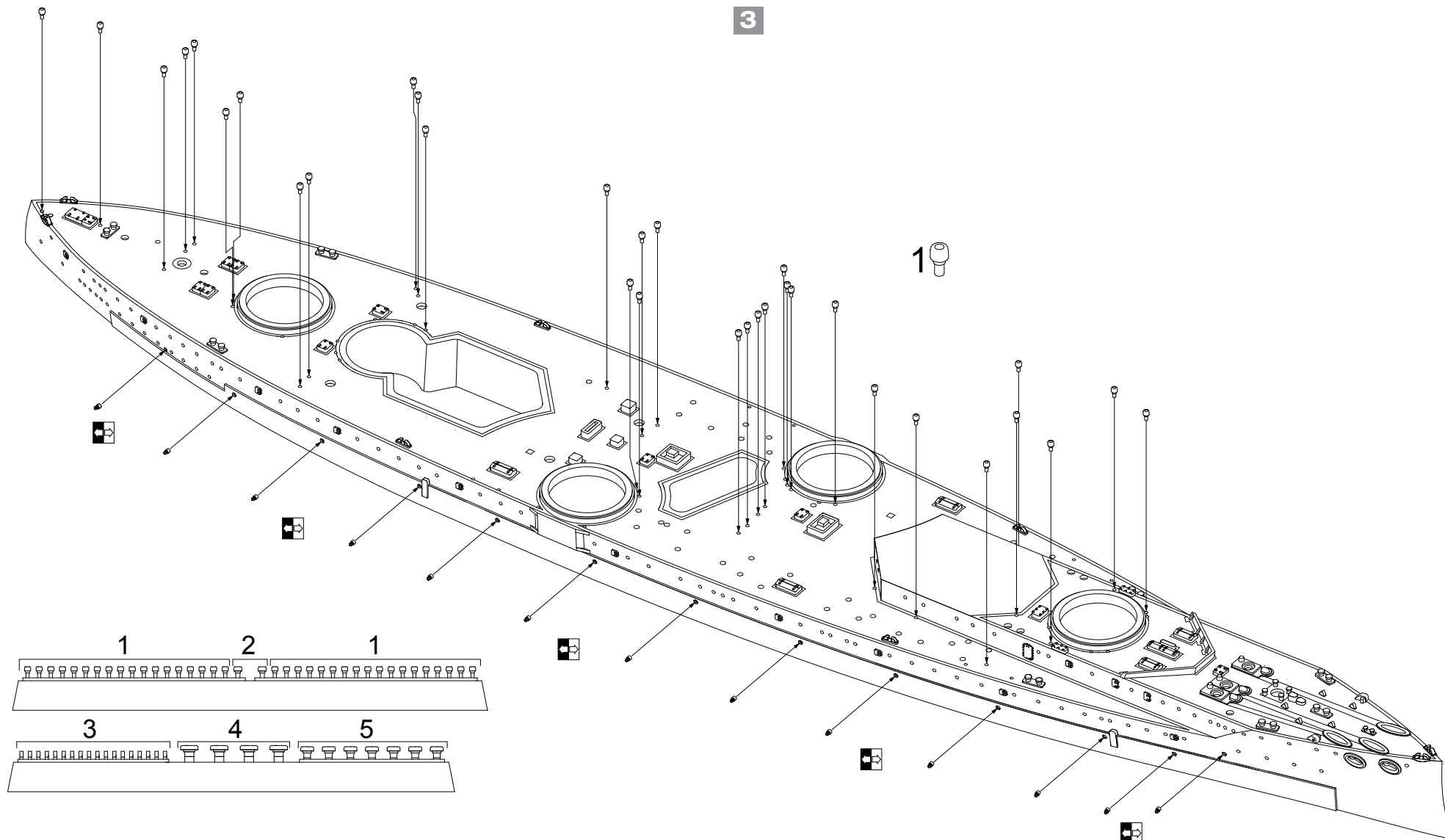

СХЕМА СБОРКИ МОДЕЛИ
ASSEMBLY INSTRUCTIONS

5

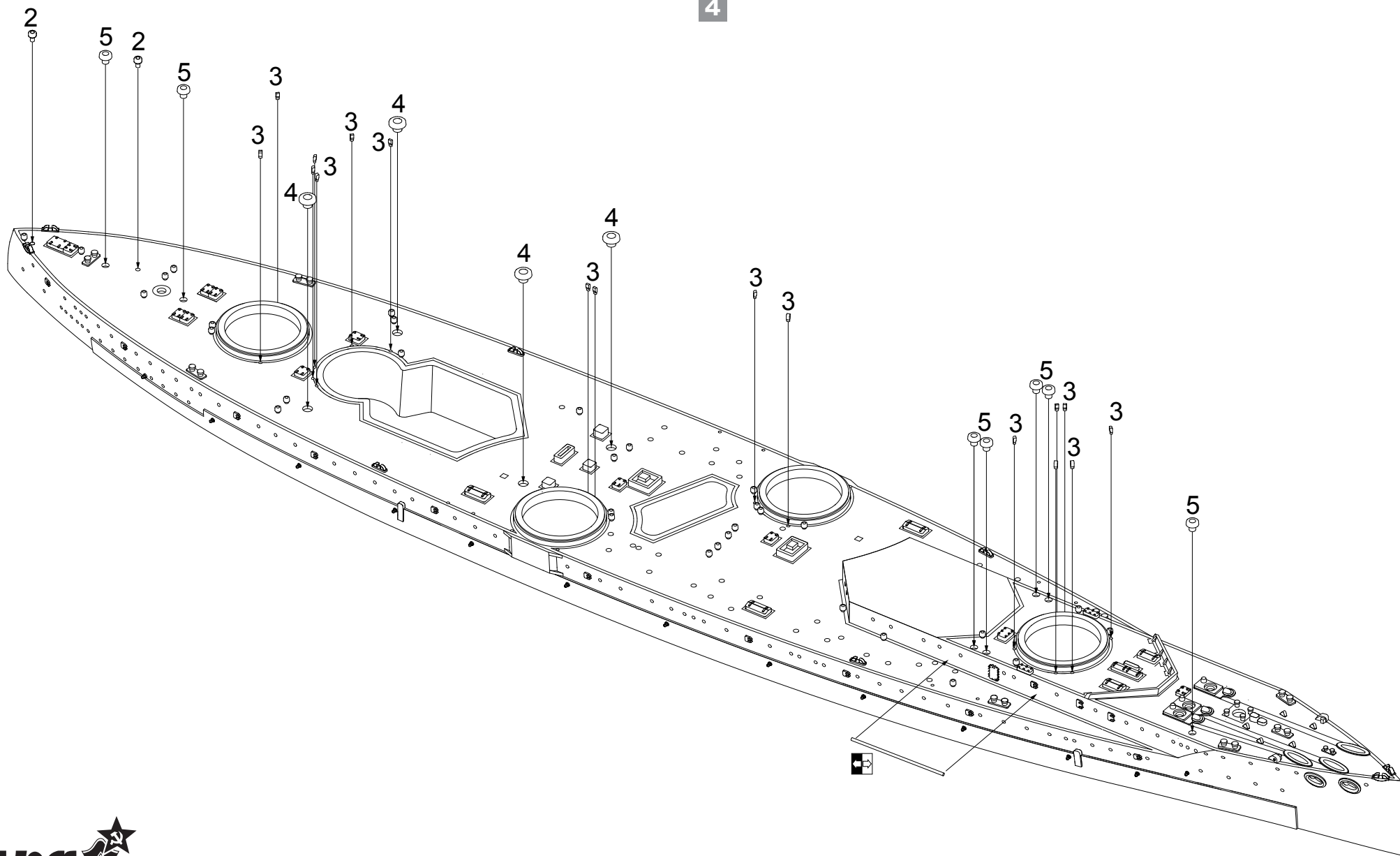

СХЕМА СБОРКИ МОДЕЛИ
ASSEMBLY INSTRUCTIONS

6

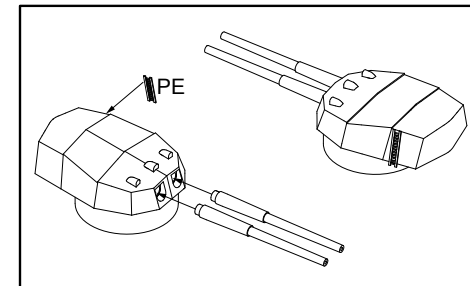
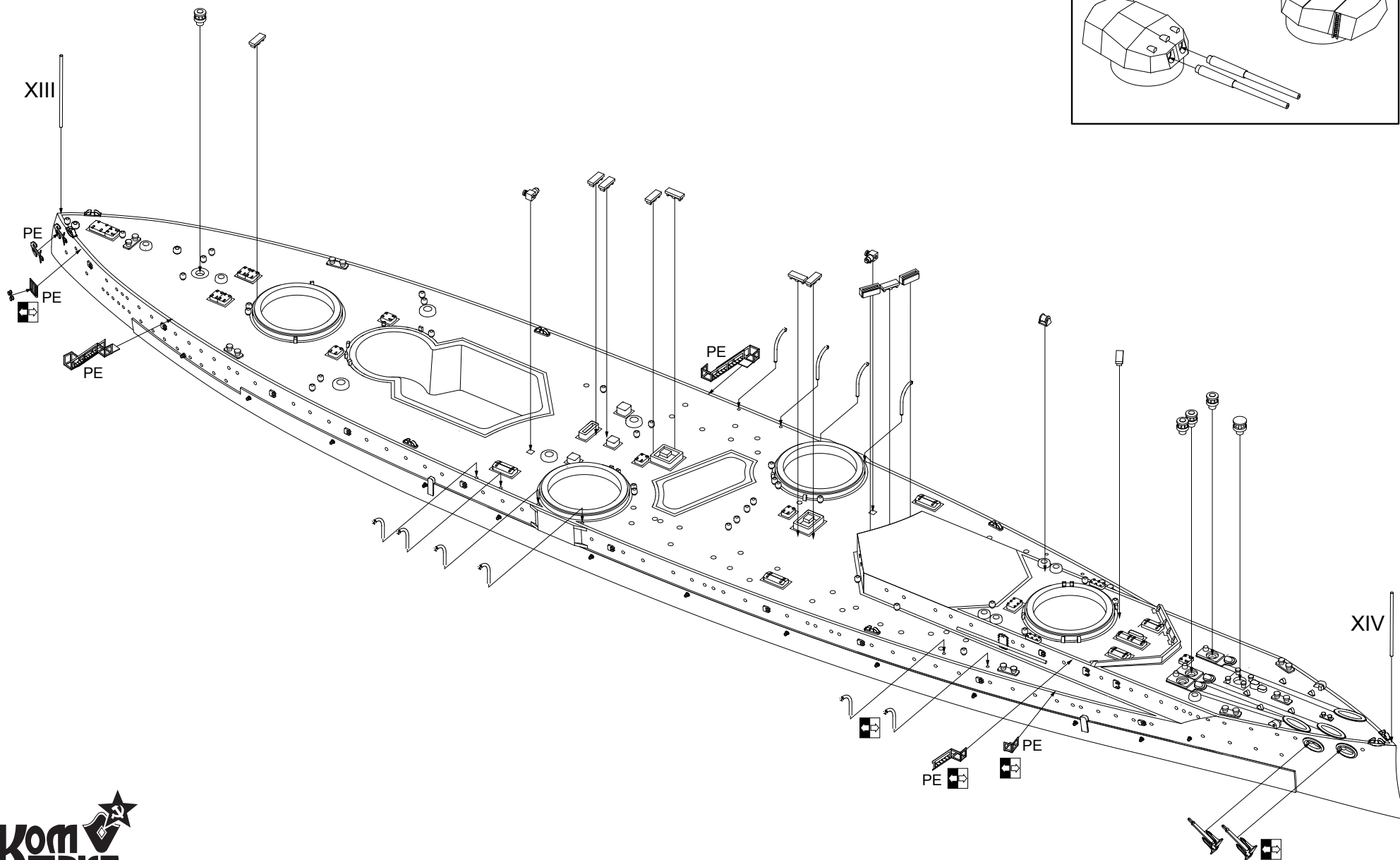

СХЕМА СБОРКИ МОДЕЛИ
ASSEMBLY INSTRUCTIONS

8

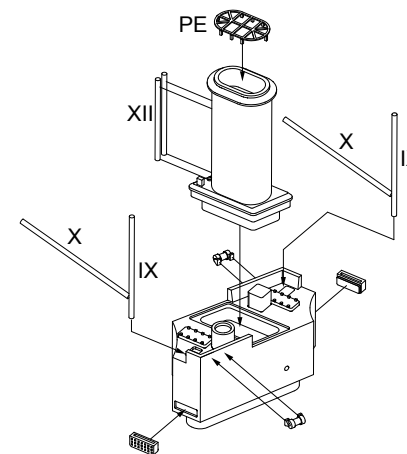
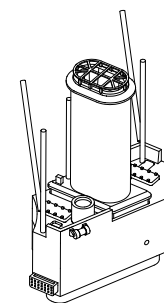
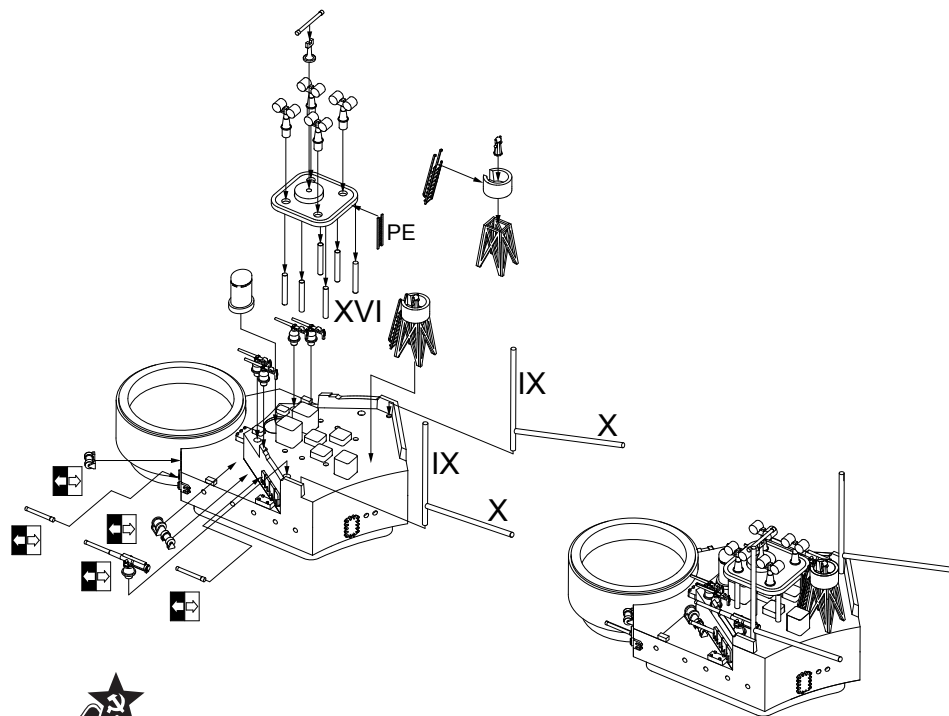
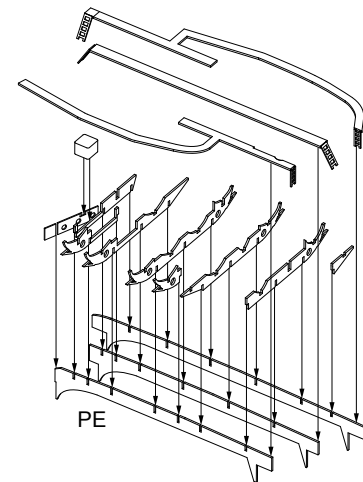
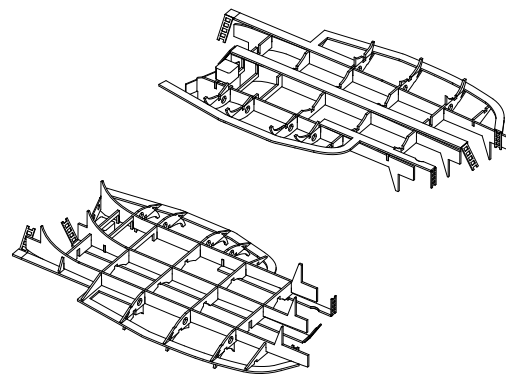
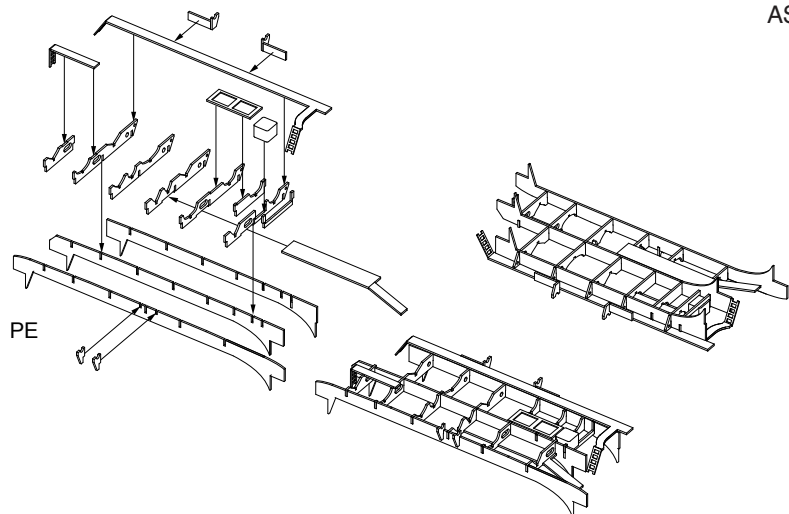

СХЕМА СБОРКИ МОДЕЛИ
ASSEMBLY INSTRUCTIONS

9

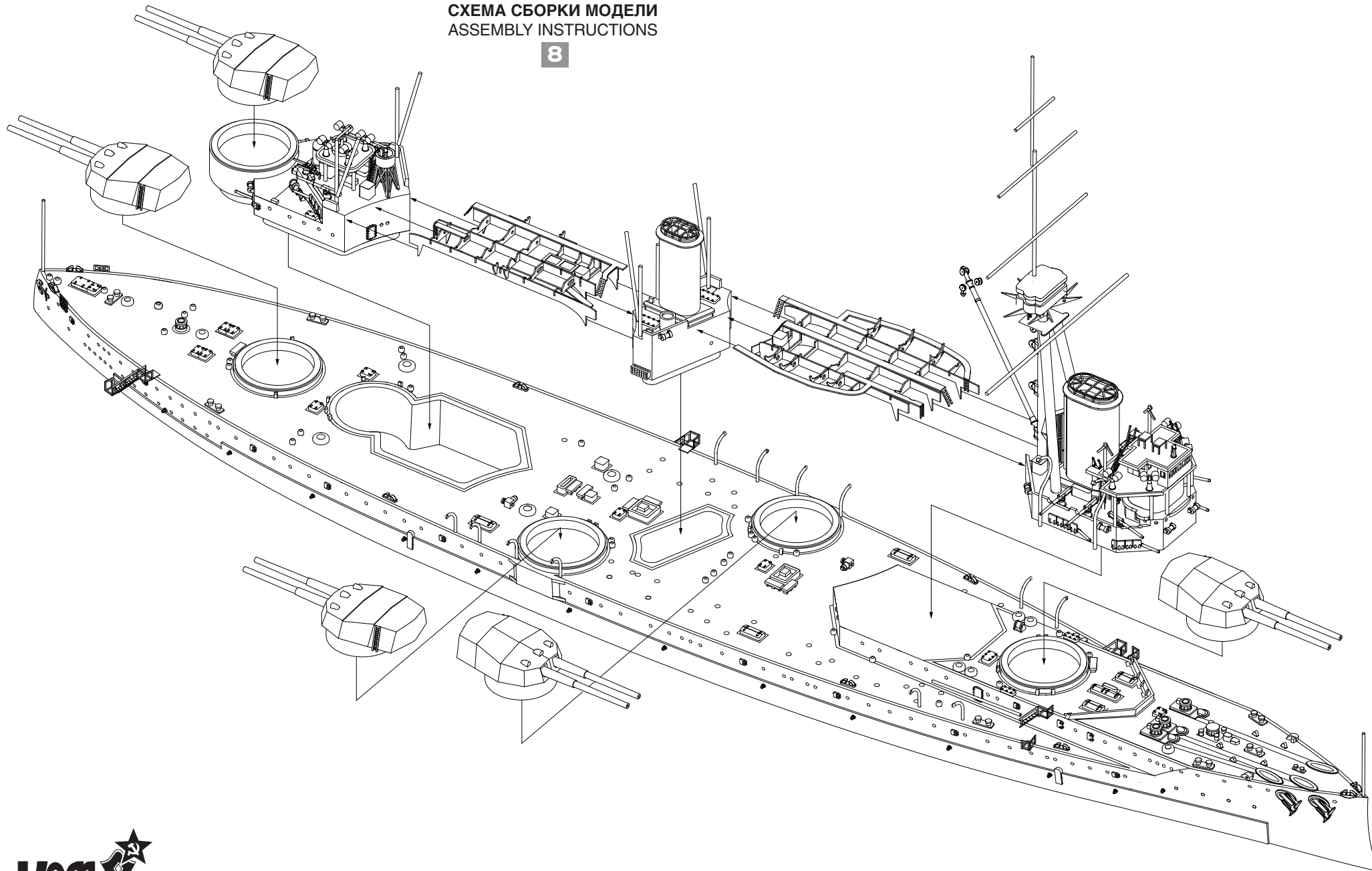

СХЕМА СБОРКИ МОДЕЛИ
ASSEMBLY INSTRUCTIONS

10

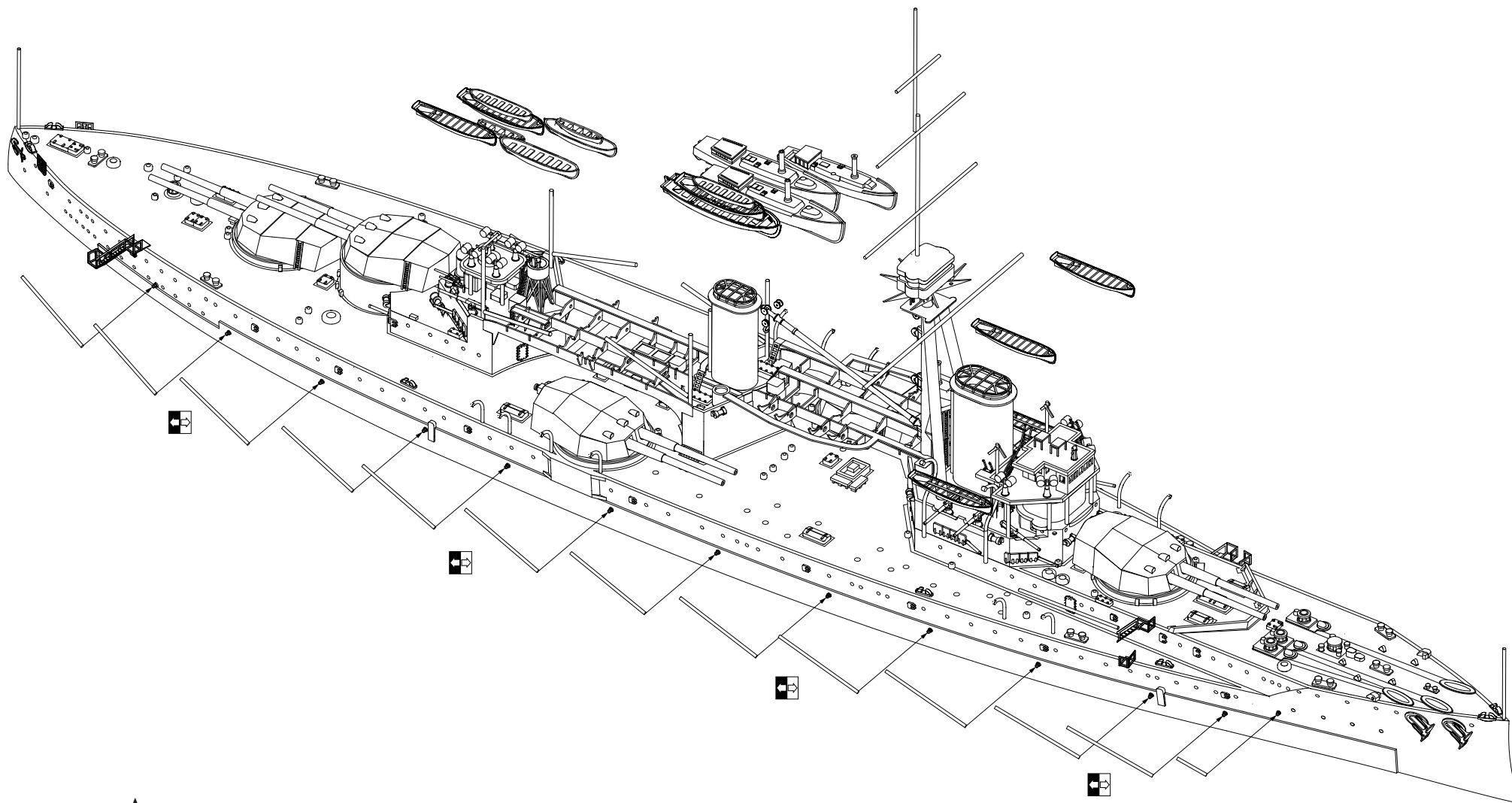